

# WEIGHT ROOM EQUIPMENT PACKAGE

## Saline Area Schools

7265 N Ann Arbor St  
Saline, MI 48176



### SHS WEIGHT RM EQUIPMENT

Saline Area Schools  
7265 N Ann Arbor St  
Saline, MI 48176



#### DIRECTORY

**OWNER/PROJECT LOCATION:**  
SALINE AREA SCHOOLS  
7265 N. ANN ARBOR ST.  
SALINE, MI 48176  
(734) 401-4000

**ARCHITECT:**  
KINGSCOTT ASSOCIATES INC.  
950 TRADE CENTRE WAY SUITE 130  
PORTAGE, MI 49002  
(800) 632-7815

#### SHEET INDEX:

FFE  
FFE-1 TITLE SHEET  
FFE-2 WEIGHT ROOM EQUIPMENT PLAN

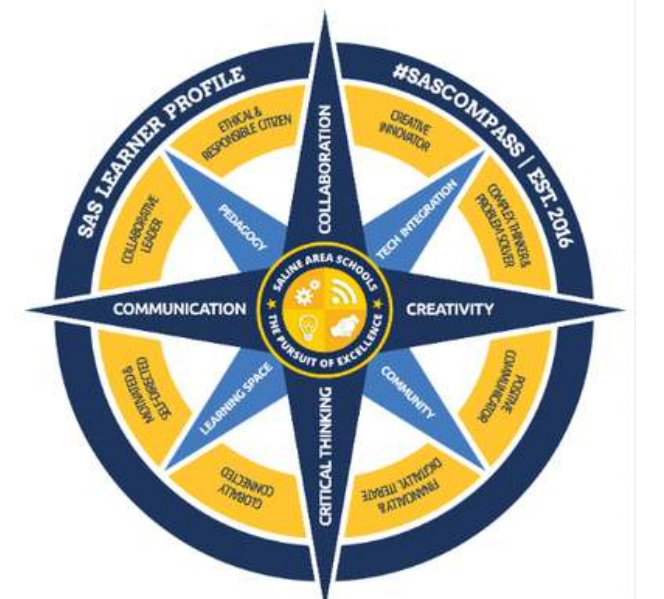

ISSUANCES DATE  
FF&E PACKAGE 12/04/2024

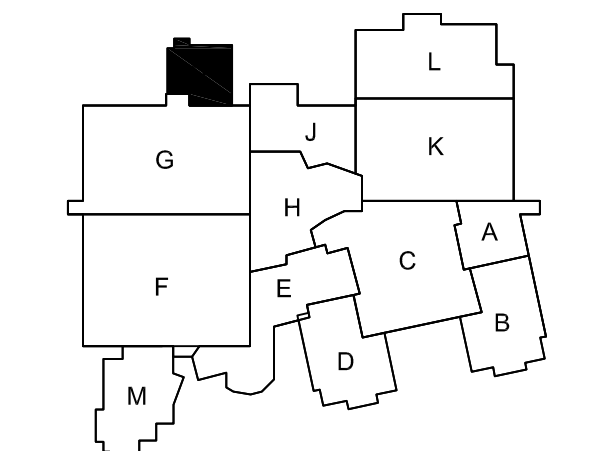

KEY PLAN

JOB NO. 2900.09

SHEET TITLE

TITLE SHEET

SHEET NO.

**FFE-1**

**EQUIPMENT GENERAL NOTES**

- REFER TO EQUIPMENT LIST FOR ALL EQUIPMENT TAGS.
- COORDINATE RACK DIMENSIONS WITH CONSTRUCTION MANAGER & KINGSCOTT TO ALIGN WITH FLOORING INSETS.

**EQUIPMENT SYMBOL KEY**

XXX BASE BID EQUIPMENT TAG. REFER TO EQUIPMENT LIST FOR SIZES AND DESCRIPTIONS  
WR-X = WEIGHT ROOM

# SHS WEIGHT RM EQUIPMENT

Saline Area Schools  
7265 N Ann Arbor St  
Saline, MI 48176

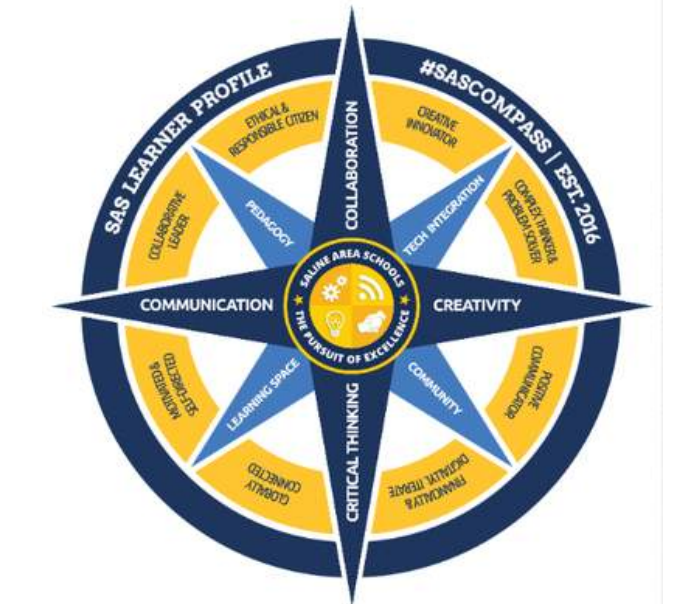

ISSUANCES	DATE
FF&E PACKAGE	12/04/2024

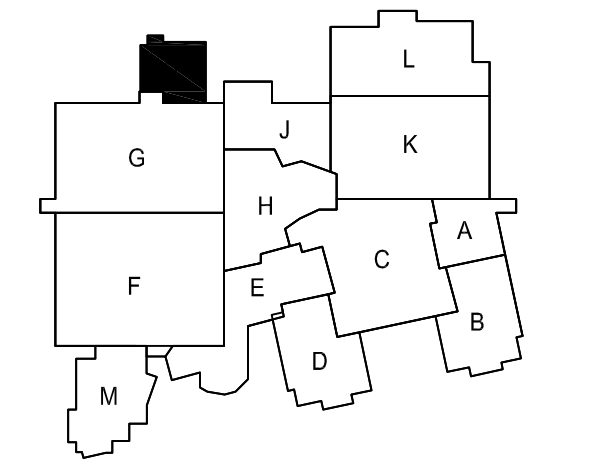

KEY PLAN

JOB NO. 2900.09  
SHEET TITLE  
WEIGHT ROOM - EQUIPMENT PLAN  
SHEET NO.

**FFE-2**

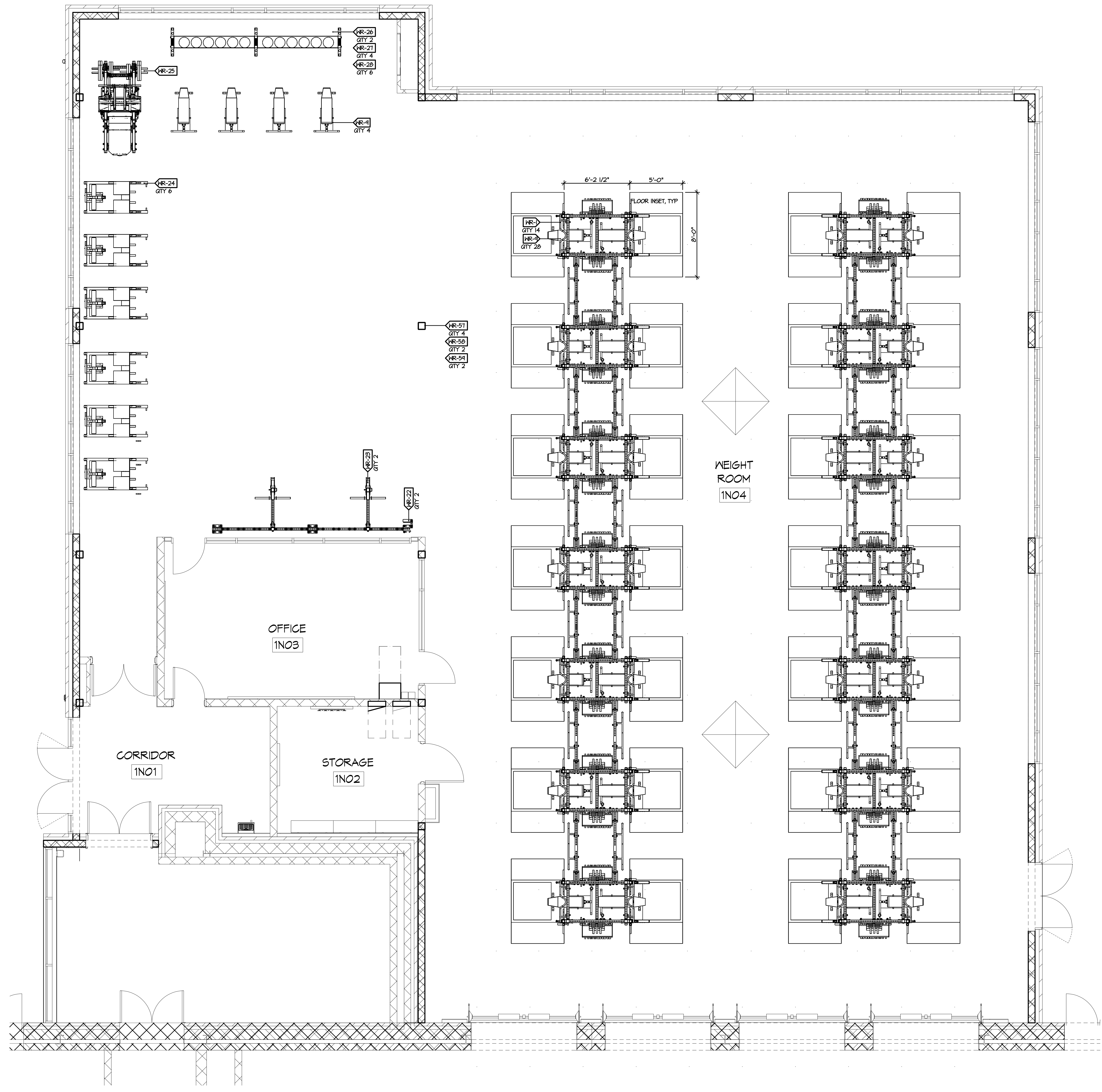

**1 WEIGHT ROOM EQUIPMENT PLAN**  
SCALE: 1/4" = 1'-0"

THESE DRAWINGS ARE THE PROPERTY OF KINGSCOTT ASSOCIATES P.C. AND ARE NOT TO BE REPRODUCED OR COPIED IN ANY MANNER WITHOUT THE WRITTEN PERMISSION OF KINGSCOTT ASSOCIATES P.C. ANY REPRODUCTION OR COPIING WITHOUT WRITTEN PERMISSION IS STRICTLY PROHIBITED.



### ARCHITECTURAL GENERAL NOTES

1. [XX] INDICATES CONSTRUCTION DOCUMENT ROOM NUMBERS.
2. REFER TO EQUIPMENT PLANS FOR CASEWORK, VISUAL DISPLAY BOARDS, LOCKERS, SHELVING, ETC.
3. REFER TO COLOR LAYOUT PLANS FOR FLOOR FINISH PATTERNS AND COLORS.
4. CONTRACTOR SHALL COORDINATE LOCATIONS OF FLOOR DRAINS, CLEAN OUTS, ETC. WITH APPROPRIATE TRADES.
5. REFER TO ENLARGED PLANS FOR ADDITIONAL NOTES AND DIMENSIONS.
6. MASONRY CONTRACTOR TO INSTALL LOOSE LINTELS FOR MISCELLANEOUS OPENINGS NOT INDICATED ON DRAWINGS BUT REQUIRED FOR MECHANICAL, ELECTRICAL, FOOD SERVICE EQUIPMENT OR OTHER ITEMS THAT PASS THROUGH A WALL. STEEL LINTELS SHALL BE SUPPLIED BY THE STEEL CONTRACTOR.
7. ALL PARTITION WALLS TO RUN TIGHT TO DECK, U.N.O.
8. REFER TO PARTITION TYPES SHOWN ON REFLECTED CEILING PLANS AND PARTITION TYPE SHEET A2.40.
9. REFER TO SHEET [ ] FOR FLOOR PLAN SYMBOLS LEGEND.
10. ALL CMU PARTITION WALLS SHALL BE 8" NOMINAL UNLESS NOTED OTHERWISE.
11. DIMENSIONS SHOWN ARE TO FACE OF CMU WALL.
12. FILL/SEAL ALL PENETRATIONS THROUGH WALLS & VOIDS AT STRUCTURAL MEMBERS.
13. ALL EXPOSED CMU CORNERS SHALL BE BULLNOSE CORNERS, U.N.O.
14. CAULK & SEAL AROUND ALL NEW CABINET HEATER LOUVERS INSTALLED IN EXTERIOR WALLS.
15. NEW OPENINGS IN EXISTING MASONRY WALLS SHALL BE TOOTHED IN TO MATCH EXISTING COURSE AND MASONRY SIZES, U.N.O.
16. [ ] INDICATES BURNISHED BLOCK WALL EXTENTS. REFER TO SPECIFICATION 042200 FOR ADDITIONAL INFORMATION.

### ARCHITECTURAL PLAN KEYNOTES

1. 5/8" GYPSUM BOARD ADHERED & MECHANICALLY FASTENED TO CMU. REFER TO PARTITION TYPES, WALL SECTIONS AND INTERIOR ELEVATIONS FOR ADDITIONAL INFORMATION.
2. PATCH EXISTING WALL CONSTRUCTION DUE TO WALL REMOVAL OR OTHER ASSOCIATED DEMOLITION. REPLACE MASONRY UNITS WHERE REQUIRED AND MATCH EXISTING ADJACENT MATERIALS AND FINISHES.
3. NEW FIRE EXTINGUISHER & EXTINGUISHER CABINET. REFER TO SPECIFICATION SECTIONS 10441B & 10441E.
4. 20'-0" STUD & GYPSUM BOARD CHASE. CONCEAL ALL SECTIONAL DOOR OPERATIONS, INCLUDING CONDUIT AND JUNCTION BOXES, IN CHASE. REFER TO INTERIOR ELEVATIONS & DETAIL 13/16.4 FOR ADDITIONAL INFORMATION.
5. EXTERIOR EXPANSION JOINT AND COVER. REFER TO SPECIFICATION SECTION 07B13.13.
6. PLYWOOD BACKER BOARD. REFER TO INTERIOR ELEVATION FOR ADDITIONAL INFORMATION.
7. NEW LADDER AND ROOF ACCESS HATCH. REFER TO DETAIL ON A5.1.
8. NOT USED.
9. NEW TOOTHED-IN 8" CMU TO MATCH EXISTING SIZE AND COURSE. INSTALL NEW CERAMIC WALL TILE TO MATCH EXISTING. INSTALL BALVALGED TOILET ACCESSORIES TO MATCH EXISTING LOCATIONS.
10. INTERIOR EXPANSION JOINT AND COVER. REFER TO SPECIFICATION SECTION 07B13.13.

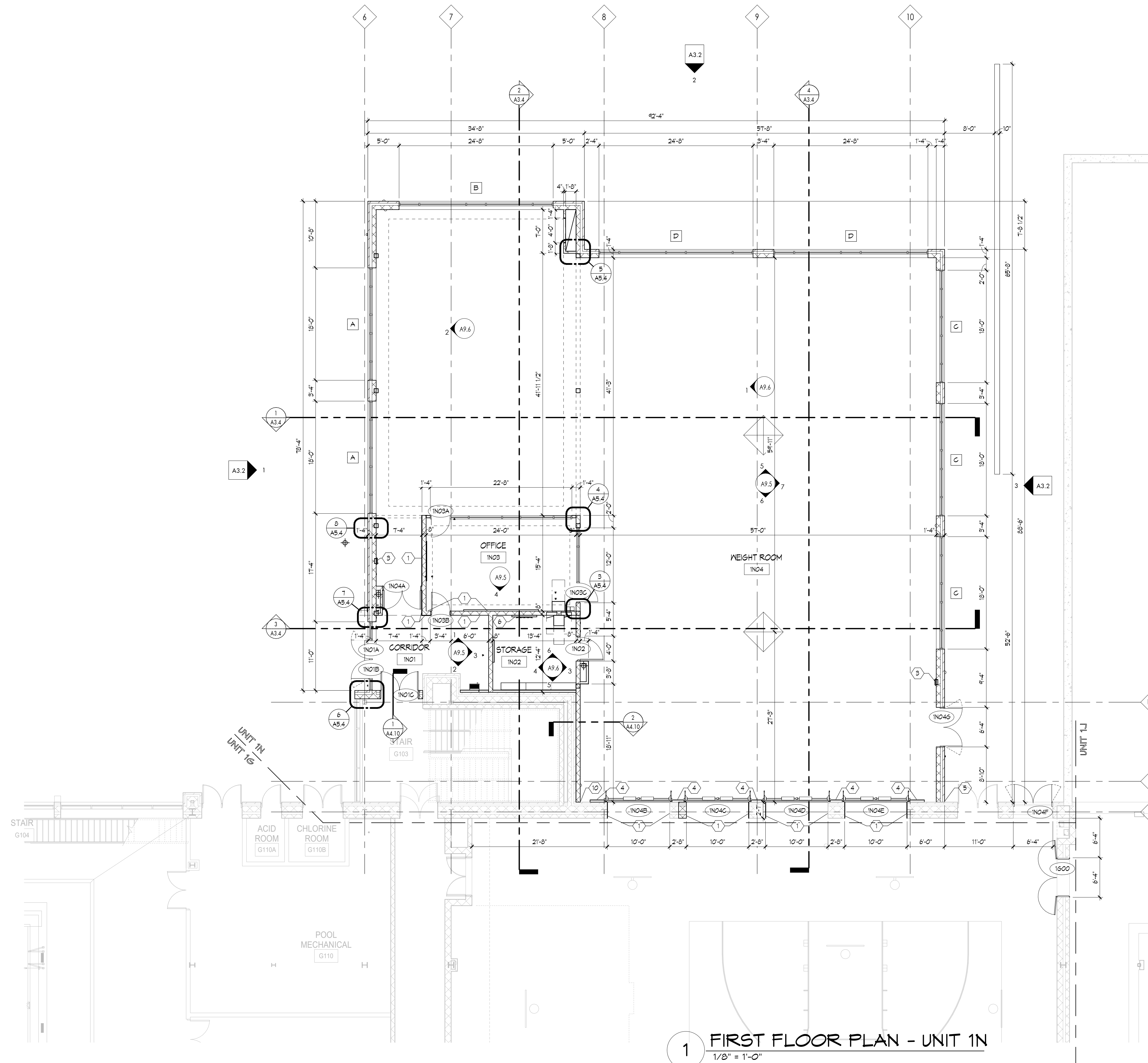

1 FIRST FLOOR PLAN - UNIT 1N  
1/8" = 1'-0"

FOR REFERENCE ONLY



# STEAM & WEIGHT ROOM ADDITION

Saline Area Schools

7265 N Ann Arbor St  
Saline, MI 48176

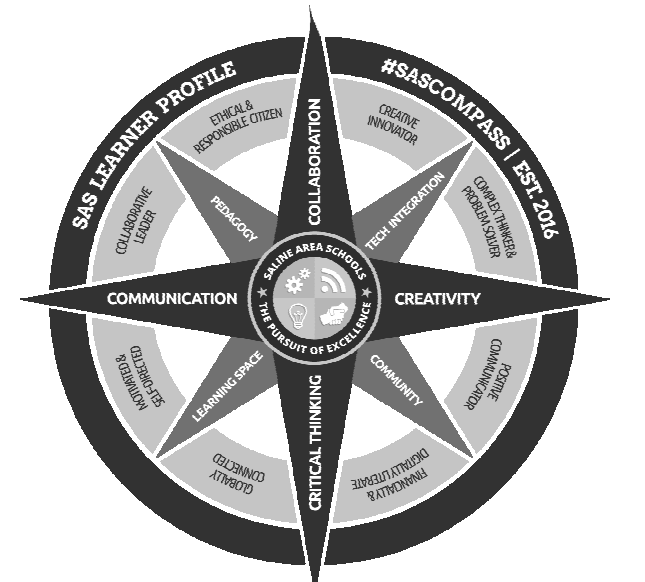

ISSUANCES CONSTRUCTION DOCUMENTS DATE 12/08/2023

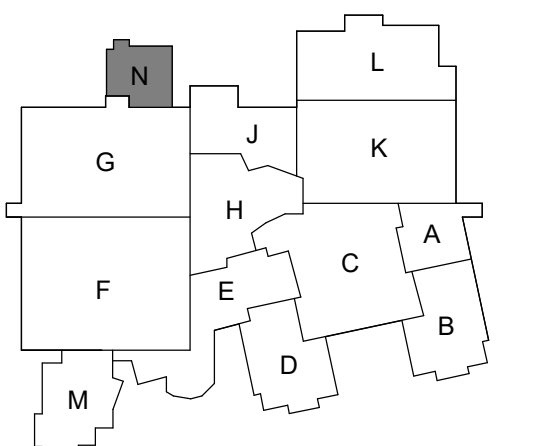

KEY PLAN

JOB NO. 2900.09C  
SHEET TITLE  
FIRST FLOOR PLAN - UNIT 1N

SHEET NO.  
**A1.13**

THESE DRAWINGS AND THE WORK REPRESENTED THEREIN ARE THE PROPERTY OF KINGSCOTT ASSOCIATES INC. AND SHALL NOT BE REPRODUCED OR TRANSMITTED IN ANY FORM OR BY ANY MEANS, ELECTRONIC OR MECHANICAL, INCLUDING PHOTOCOPYING, RECORDING, OR BY ANY INFORMATION STORAGE AND RETRIEVAL SYSTEM, WITHOUT THE WRITTEN PERMISSION OF KINGSCOTT ASSOCIATES INC. © 2023 KINGSCOTT ASSOCIATES INC. SALINE, MI