



11/27/2024

## ADDENDUM NO. 2

PROJECT: Saline Area Schools – 2022 Bond Program –  
MS Rec Complex  
DESCRIPTION: Addendum No.2  
BID PACKAGE RELEASE NUMBER: BP #3

**BID PROPOSAL DUE DATE/TIME:** 2:00 PM, Wednesday, December 11<sup>th</sup>, 2024

---

The following clarifications and/or Changes made to the Contract Documents are hereby made part of the Contract Documents.

The general character of the Work clarified or revised by this Addendum shall be the same as required by the complete set of Contract Documents. All incidentals required in connection with the Work of this Addendum shall be included in the Scope of Work even though not specifically specified.

All bidders shall be held responsible to review the Addendum and to include in its Bid Proposal all Work reasonably inferred to be included in its Scope of Work.

**Acknowledge receipt of this Addendum in the space provided on the Bid Proposal Form.**

---

**A. Division 00 – Bidding and Contract Requirement Modifications:**

**1. SECTION 002113 - INSTRUCTIONS-TO-BIDDERS**

- i. Revised and reissued.

**2. Section 002416 – Scope of Work – Bid Category Specific Notes**

- i. Attachment A – Bid Category Scope Delineation
- ii. Bid Category 02 – UST System Removal (Reissued)
- iii. Bid Category 03 – Concrete (Reissued)
- iv. Bid Category 31A – Sitework (Reissued)
- v. Bid Category 32A – Asphalt (Reissued)

*Saline Area Schools – 2022 Bond Program*

Bid Release No. 3 REC Complex

Addendum No. 002

Page 1 of 2

**B. Architect/Engineering Documentation**

1. ADDENDUM No. 2, November 26<sup>th</sup>, 2024 as issued by Kingscott (Attached)

**C. Pre-Bid RFI's**

1. Attached Pre-bid RFI's

END OF SECTION

---

SECTION 002113  
INSTRUCTIONS TO BIDDERS

**1. DEFINITIONS**

- 1.1. All definitions set forth in the General Conditions of the Contract for Construction are applicable to these Instructions to Bidders.
- 1.2. **Bid Documents:** include the Contract, the General Conditions, Division 00 – Procurement and Contracting Requirements, Division 01 – General Requirements, Design Drawings and Specifications, and Addenda.
- 1.3. **Bid Release:** a set of Bid Documents.
- 1.4. **Bid Category:** areas of Work performed by a Trade Contractor and its Subcontractors.
- 1.5. **Addenda:** written or graphic instruments issued prior to the execution of the Contract which modify or interpret the Bid Documents, including Drawings and Specifications, by additions, deletions, clarifications or corrections.
- 1.6. **Bid:** a proposal prepared and submitted as required herein.
- 1.7. **Trade Contractor:** shall refer to the entity contracted to perform the Work of one or more Bid Categories whether referred to in the Contract Documents as Contractor, Subcontractor or Trade Contractor.

**2. BIDDER'S REPRESENTATION**

- 2.1. Each Bidder, by submitting a Bid, represents that the Bidder has read and understands the Bid Documents, has visited the site and is familiar with the local conditions under which the Work is to be performed and has made its own review therefore of the facilities and difficulties attending the performance and completion of the Work.

**3. BIDDING PROCEDURES**

- 3.1. Combined Bids of two or more Bid Categories may be submitted.
- 3.2. All Bids must be submitted on the unaltered Bid Proposal Forms provided as part of the Bid Documents and in accordance with these Instructions to Bidders.
- 3.3. Each Bidder shall ascertain prior to submitting a Bid that it has received all Addenda issued and shall acknowledge receipt on the Bid Proposal Form.
- 3.4. All Bids must be signed as follows:
  - A. Corporations: Signature of official shall be accompanied by a certified copy of the resolution of the board of directors authorizing the individual signing to bind the corporation.

---

SECTION 002113  
INSTRUCTIONS TO BIDDERS

- B. Partnerships: Signature of one partner shall be accompanied by a certified copy of the power of attorney authorizing the individual signing to bind all partners. If a certified copy of the partnership's certificate submitted with the Bid indicated that all partners have signed, no authorization is required.
  - C. Bids submitted by joint ventures shall be signed by one of the joint ventures and shall be accompanied by a certified copy of the power of attorney authorizing the individual signing to bind all the joint ventures.
  - D. Individual signing on own behalf: No authorization is required.
  - E. Individual signing on behalf of another: Power of attorney or comparable evidence of authority shall accompany Bid.
- 3.5. Bids that are submitted as a hard copy shall be submitted in an opaque, sealed envelope. Facsimile and email Bids will not be accepted.
- 3.6. A Bid shall be invalid if it is not delivered to the location indicated in the Advertisement/Invitation for Bids on or before the required Bid Due Date and time.
- 3.7. No responsibility shall attach to the Construction Manager, the Owner, or representatives of either, for premature opening of any Bid, which is not properly addressed, delivered and identified.
- 3.8. Negligence in preparation, improper preparation, error in and/or omissions from the Bid shall not relieve the Bidder from fulfillment of any and all applicable obligations and requirements of the contract documents.
- 3.9. The Owner, Architect/Engineer or Construction Manager, in making copies of the Bid Documents available, do so only for the purpose of obtaining Bids on the Work and do not confer a license or grant for any other use.
- 3.10. All Bids submitted shall be for the specified base scope of Work with no exceptions. Exceptions in the base Bid may be considered as basis for rejection.
- 3.11. Voluntary alternates will be considered at the Architect and Owner's discretion.
- 3.12. Bidder shall not modify, withdraw or cancel a Bid or any part thereof for ninety (90) days after the time designated for the Due Date of Bids.

**4. FAMILIAL DISCLOSURE**

- 4.1. All Bidders shall provide familial disclosure in compliance with MCL 380.1267 and attach this information to the Bid. The Bid shall be accompanied by a sworn and notarized statement disclosing any familial relationship that exists between the Owner or any employee of the Bidder and any member of the Board of Education of the school district, or the Superintendent of the school district. The District will

---

SECTION 002113  
INSTRUCTIONS TO BIDDERS

not consider a Bid that does not include this sworn and notarized statement. If the bid is submitted electronically, the original document shall be delivered to the District prior to a recommendation for award to the Board of Education.

**5. IRAN ECONOMIC SANCTIONS ACT**

5.1. Each Bid must be accompanied by a sworn and notarized statement certifying that the Contractor is not an “Iran linked business” within the meaning of the Iran Economic Sanctions Act. **The Board of Education of the School District will not consider or accept a Bid that does not include this sworn and notarized statement.** If the bid is submitted electronically, the original document shall be delivered to the District prior to a recommendation for award to the Board of Education.

**6. CRIMINAL BACKGROUND CHECKS**

6.1. Each Bid must be accompanied by a sworn and notarized Affidavit of Compliance – Criminal Background Checks. **The Board of Education of the School District will not consider or accept a Bid that does not include the sworn and notarized statement.** If the bid is submitted electronically, the original document shall be delivered to the District prior to a recommendation for award to the Board of Education.

6.2. Saline Area requires all Contractor owners, employees, agents, representatives, subcontractors, and/or other personnel who will be present on School grounds to submit to a criminal history background check. This background check will include a requirement for each contractor owner, employee, agent, representative, subcontractor, and/or other personnel to be screened before he/she enters School grounds. A valid State ID card or Driver’s License is required to complete the background check. Once screened, the District will provide approved personnel with a Contractor Badge with a unique number.

**7. EXAMINATION OF BIDDING DOCUMENTS**

7.1. Each Bidder shall examine the Bidding Documents carefully and, not later than seven (7) days prior to the Due Date of Bids, shall make written request to Clark Construction Company for interpretation or correction of any ambiguity, inconsistency or error therein discovered. Only written interpretation or correction by Addendum shall be binding.

7.2. Each Bidder shall submit a Bid based on the entire set of Bid Documents. Bidders shall review all Drawings and Specifications to identify Work related to its respective Bid category. Complete sets of Drawings are available for review at the locations indicated in the Advertisement/Invitation for Bids.

---

SECTION 002113  
INSTRUCTIONS TO BIDDERS

- 7.3. Failure to review the complete set of Bid Documents and to identify items reasonably interpreted to be in the scope of the Bid Category shall not relieve the Trade Contractor of its responsibility to perform the Work.
- 7.4. Any incidental item of material, labor or detail, required for proper execution and completion of the Work, omitted from the Bid Documents, but required by governing codes, local regulations, trade practices, operational functions, and quality workmanship, shall be provided as part of the contract Work at no additional cost, even though not specifically detailed or noted.
- 7.5. Trade Contractor shall not scale Drawings to obtain dimensions.

**8. BIDDER'S EXAMINATION OF PREMISES**

- 8.1. The Bidder represents that it has carefully inspected the Project site and examined the Drawings and Specifications and other Contract Documents and is familiar with and has satisfied itself as to the nature, location and amount of the Work, the Bidder's access thereto and ability to perform the Work, local code requirements applicable to the Work and requirements of permits and inspections, safety and barricade requirements, the terms and conditions of any applicable project labor and collective bargaining agreements, as well as the quality, quantity and availability of labor, materials, equipment and facilities and other items required for the performance of the Work and the possible limiting physical and other conditions which may be encountered in the performance of the Work and assumes all risks therefrom. The Bidder has determined, by its own investigation and research, all the conditions affecting the Work to be performed and materials to be furnished and does not rely upon any representation by the Owner or Construction Manager in connection therewith. In performing the Work, Bidder accepts the condition of the Project site as-is and assumes the risks with regard to existing conditions at the Project site.
- 8.2. The Bidder shall take its own measurements and be responsible for the correctness of same.
- 8.3. The Bidder shall be held to have made such examinations of the premises and no allowances will be made on its behalf by reason of error or omission on its part.
- 8.4. Plans, diagrams and other descriptive information which depict existing conditions are provided for scope identification and scheduling purposes only. Quantities, elevations, measurements and locations shown may have been approximated and/or gathered from dated, incomplete original construction documents. This data should not be used for bidding purposes without field verification by the Bidder.
- 8.5. The Bidder's own Bid Document review and site inspection review of the Work areas shall be relied upon to provide the Bidder information he/she may require to properly execute and complete the Work. Questions must be submitted in writing

---

SECTION 002113  
INSTRUCTIONS TO BIDDERS

to the Construction Manager at least seven (7) days before the date for receipt of Bids to allow time for written Addenda to be issued.

- 8.6. Each Bidder shall examine the premises carefully and, not later than seven (7) days prior to the date for receipt of Bids, shall make written request to Clark Construction Company for any additional information required. Only written interpretation or correction by Addendum shall be binding.

**9. SUBSTITUTIONS**

- 9.1. Each Bid shall be based upon materials and equipment described in the Bid Documents.

- 9.2. Material and equipment substitutions will not be considered unless written request has been submitted for approval at least fourteen (14) days prior to Bid Due Date. Only approvals in a written Addendum shall be binding. Each substitution request shall include the following:

- A. Complete description of the proposed substitution.
- B. Information regarding specified material or equipment for which substitution is being submitted.
- C. Drawings.
- D. Manufacturer's literature.
- E. Performance and test data.
- F. Effect on performance characteristics.
- G. Impact on the Work of other trades.
- H. Any other data or information necessary for a complete evaluation.

**10. RESERVATION OF RIGHTS**

- 10.1. The Owner reserves the right, in its sole and absolute discretion (for this provision and all other provisions contained in this RFB), to accept or reject, in whole or in part, any or all Bids. The Owner further reserves the right to waive any irregularity or informality in this RFB process or any Bid, and the right to award the Contract to other than the low Bidder(s). The Owner reserves the right to request additional information from any or all Bidders. The Owner reserves the right to select one or more Bidders. In the event a Bidder's Bid is accepted by the Owner and Bidder asserts exceptions, special considerations or conditions after acceptance, the Owner, in its sole and absolute discretion, reserves the right to thereafter reject the Bid and award the Contract to another Bidder.

---

SECTION 002113  
INSTRUCTIONS TO BIDDERS

**11. OWNER RIGHTS**

11.1. Bidder acknowledges the right of the Owner to accept or reject in whole or in part, any or all Bids and to waive any informality or irregularity in any Bid received. In addition, the Bidder recognizes the right of the Owner to reject a Bid for any reason including but not limited to the following:

- A. Bidder fails to furnish or submit data required in the Bidding Documents;
- B. Bid is in any way incomplete or irregular;
- C. Bidder's performance as a Trade Contractor was unsatisfactory under a prior contract for the construction, repair, modification, or demolition of a facility with the Owner, Construction Manager or Architect;
- D. Known poor performance on prior contracts with parties other than the Construction Manager, Owner or Architect; or
- E. Unsatisfactory financial condition.
- F. Unsatisfactory safety record

11.2. The Owner may accept alternates that serve its own best interest. The Owner shall have the right to accept alternates in any order or combination and to determine the low Bidder based on the sum of the base Bid and Bid alternates accepted.

11.3. Bidders to whom the award of a Contract is under consideration shall complete the Clark Construction Company Online Prequalification database as follows. Firms having previously filled out Clark Construction Company's Online Prequalification database shall confirm and/or update the information.

- A. Follow the link below to the Clark Construction Pre-Qualification Website.
  - 1. [Clark Construction Company Pre-qualification Form \(clarkcc.com\)](https://www.clarkcc.com/pre-qualification-form)
- B. Click on the Pre-Qualification button.
- C. Upload required information into the database.
- D. After completion of uploading, updating, or confirming your firm's information notify James Temple (JTemple@clarkcc.com). Provide Bid Categories for which your firm desires to be prequalified.
- E. For questions or issues using the online system, contact Jessica Ream (517) 281-6280.



---

SECTION 002113  
INSTRUCTIONS TO BIDDERS

**12. EQUAL OPPORTUNITY EMPLOYMENT POLICIES**

12.1. The Bidder agrees that it will not discriminate against any employee or applicant for employment because of race, religion, color, sex, national origin, or age. The Bidder shall take affirmative action to ensure that applicants are employed and that employees are treated during employment without regard to race, religion, color, sex, or national origin.

**13. BID SECURITY**

13.1. Each Bid must be accompanied by a Bid security in an amount of not less than 5% of the total base Bid sum, pledging that the Bidder will enter a Contract with the Saline Area Schools under the terms stated in the Bid Documents. Bid Bonds shall be issued by a bonding company meeting the requirements as described in Section 006113 Performance and Payment Bond. Bid security may also be in the form of a certified check made out to the School District.

13.2. The Owner shall have the right to retain the Bid security of Bidders under consideration until either:

- A. the Contract has been executed and bonds and insurance have been furnished, or
- B. the specified time has elapsed so that Bids may be withdrawn, or
- C. All Bids have been rejected.

13.3. The amount of the Bid security shall be forfeited to the Owner upon failure of the successful Bidder to enter into a Contract and provide all required Bonds and Insurance to the Construction Manager within fifteen (15) days after acceptance of the Bid.

13.4. If the bid is submitted electronically an original copy of the bid bond must be sent to the District prior to a recommendation for award of contract to the Board of Education. If the electronic bid contains a check, the check must be delivered to the District within 72 hours of the bid submission due date and time.

**14. PERFORMANCE AND LABOR AND MATERIAL PAYMENT BONDS**

14.1. The Bidder shall, within 10 days after the acceptance of any Bid, provide a Labor and Material Payment and Performance Bond, each covering the full amount of the Contract sum as security for the faithful performance of all Work under the Contract and payment of all charges in connection therewith. (Refer to “Performance and Payment Bond” section). **Cost of said bonds shall be included in the Base Bid.**

---

SECTION 002113  
INSTRUCTIONS TO BIDDERS

14.2. The Owner has the right to waive the performance and labor and material payment bond if the Bid is under \$50,000.

**15. PERMIT COMPETITION**

15.1. The name of a model, manufacturer, or brand in this RFB shall not be considered as exclusive of other brands. Brands and models specified in this RFB are preferred. All supplies, materials, equipment, or products Bid by a Bidder shall meet or exceed the specifications set forth in this RFB.

15.2. It is the Owner's intent that this RFB permit competition. Accordingly, the use of any patent, proprietary name or manufacturer's name is for demonstrative purposes only and is not intended to curtail competition. Whenever any supplies, material, equipment or products requested in this RFB are specified by patent, proprietary name or by the name of the manufacturer, unless stated differently, such specification shall be considered as if followed by the words "or comparable equivalent," whether or not such words appear.

15.3. The Owner, in its sole and absolute discretion, shall have the right to determine if the proposed equivalent products/brands submitted by Bidder meet the specifications contained in this RFB and possess equivalent and/or better qualities.

15.4. It is the Bidder's responsibility to notify the Construction Manager in writing not later than 14 days prior to the bid Due Date if any specifications or suggested comparable equivalent products/brands require clarification. Any and all Bid deviations from Specifications must be noted on the Bid Form.

**16. LATE BIDS**

16.1. Each Bidder is responsible for the submission of its Bid. Bids or Bid revisions received after the Due Date will not be accepted or considered. The Owner is not liable for any delivery or postal delays.

**17. RETURNED BIDS**

17.1. All Bids received after the Due Date will be unopened and made available to the respective Bidder for pick-up, at their sole cost and expense for a period of two (2) weeks after the Due Date.

**18. CONTRACT ASSIGNMENT OR SUB-CONTRACT**

18.1. The Contract shall not be assigned, transferred, or sublet, in whole or in part, by the Bidder without the prior written consent of the Owner.

**19. SUBCONTRACTORS**

19.1. All Trade Persons shall be thoroughly experienced in the particular class of Work in which they are employed.

19.2. Nothing contained in the Contract shall create a contractual relationship between the Owner and any third party, including any Subcontractor of the Bidder. The Bidder shall be responsible for the management of its Subcontractors in their performance of their work. When using Subcontractors, the Bidder shall be fully

---

SECTION 002113  
INSTRUCTIONS TO BIDDERS

responsible to the Owner for the acts and omissions of its Subcontractors and of persons employed or directly employed by the Bidder as if the Subcontractors were employees of the Bidder.

**20. RELEASE OF CLAIMS**

20.1. Each Bidder by submitting its Bid releases the Owner, Construction Manager and Architect from any and all claims arising out of, and related to, this RFB process and selection of a Bidder.

**21. BIDDER BEARS BID COSTS**

21.1. A recipient of this RFB is responsible for any and all costs and liabilities incurred by it or others acting on its behalf in preparing or submitting a Bid, or otherwise responding to this RFB, or any negotiations incidental to its Bid or this RFB.

**22. COLLUSIVE BIDDING**

22.1. The Bidder certifies that its Bid is made without any previous understanding, Contract or connection with any person, firm or corporation making a Bid for the same Works and is in all respects fair, without outside control, collusion, fraud or otherwise illegal action.

**23. FINALITY OF DECISION**

23.1. Any decision made by the School District, including the Bidder selection, shall be final. Each Bidder by submitting its Bid releases the School District from any and all claims arising out of, and related to, this bidding process and selection of a Bidder.

**24. INCORPORATION BY REFERENCE**

24.1. The Contract shall incorporate by reference this RFB and the Bidder's Bid. It is acknowledged by the Bidder that exceptions or special conditions of the Bidder will not be binding upon the School District unless those exceptions or special conditions are expressly accepted by the School District, and specifically incorporated into the final Contract.

**25. GOVERNING LAW**

25.1. The Contract shall be governed by and construed in accordance with the laws of the State of Michigan. The parties hereby agree to the exclusive jurisdiction and venue of courts sitting in Macomb County, Michigan.

END OF SECTION

# Asphalt Delineation Example

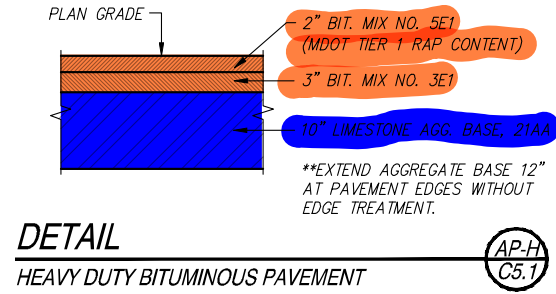

- 31A - Furnish, Grade and Compact 6" Class II Sand Base
- 32A - Fine Grade

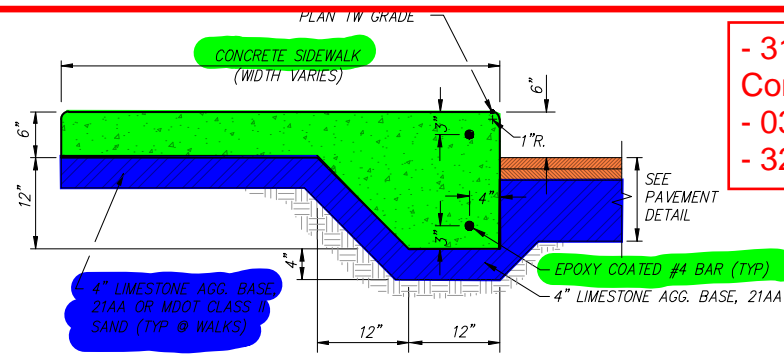

- 31A - Furnish, Grade and Compact 6" Class II Sand Base
- 03 - Fine Grade
- 32A - Fine Grade

# Concrete Sidewalk, Curb and Asphalt Delineation Example

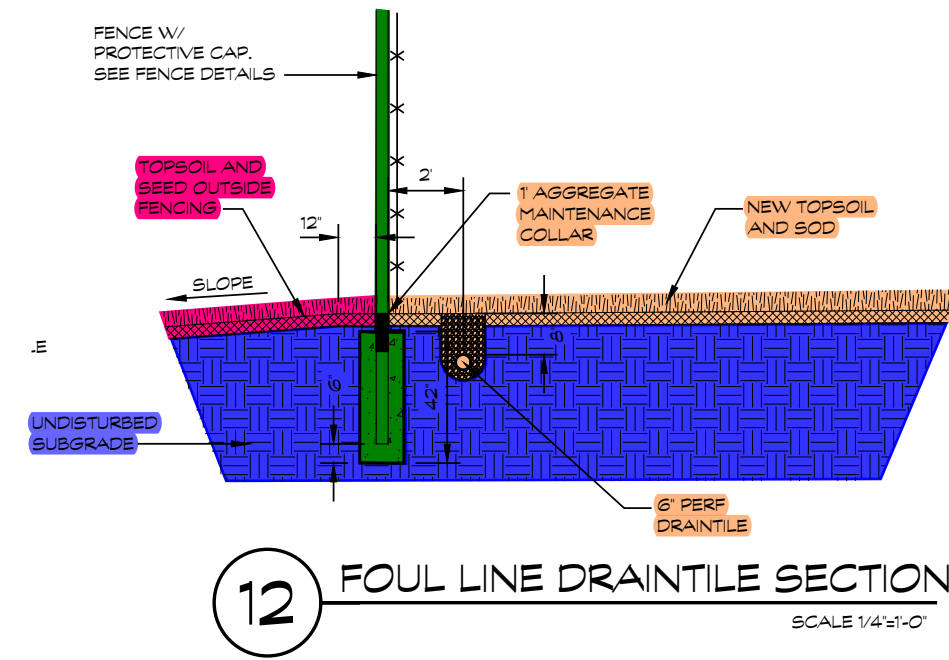

- 31A - Grade and compact subgrade as required
- 31B - Furnish, place and grade topsoil, sod, maintenance strip, etc. inside baseball fields
- 32F - Furnish, place and grade topsoil, seed, mulch, etc. all other areas

# Baseball & Softball Field Delineation Example

- 31A - Sitework
- 32A - Asphalt
- 03 - Concrete
- 32B - Turf
- 32C - Track Surface
- 32F - Landscaping
- 31B - Ball Field Sitework
- 32D - Tennis Court Surfacing

- 31A - Furnish, Grade and Compact 6" Class II Sand Base
- 03 - Fine Grade

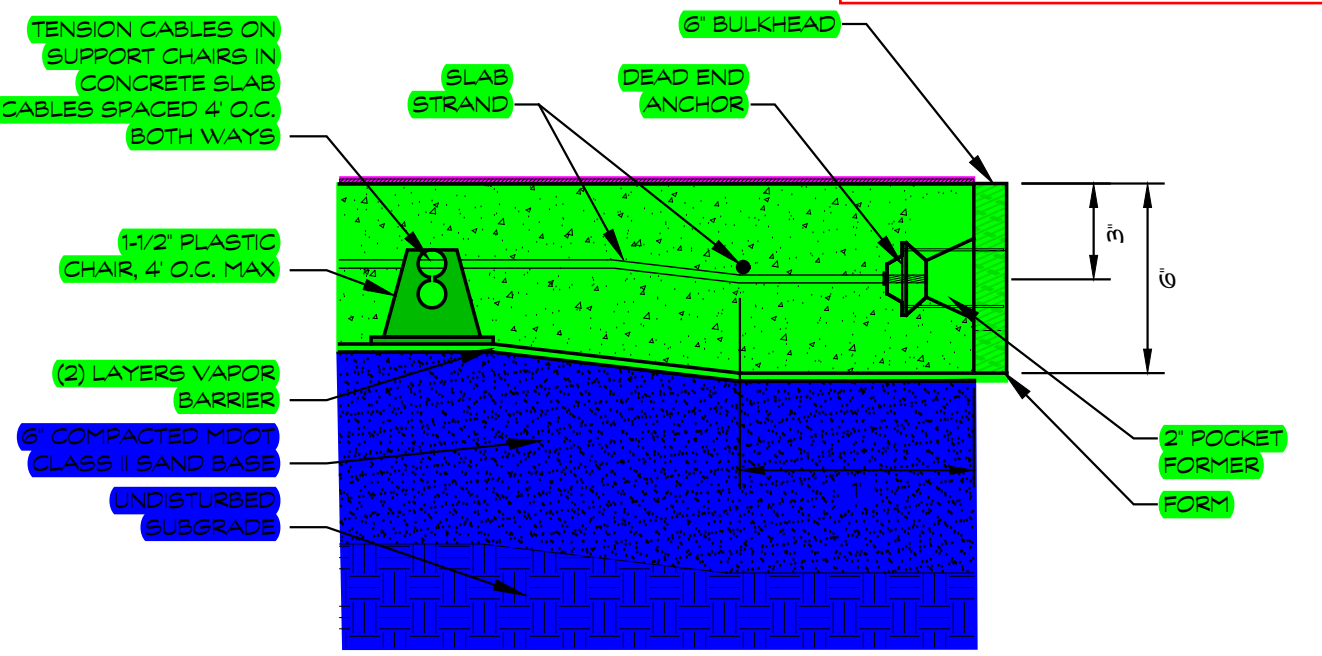

# Tennis Court Delineation Example

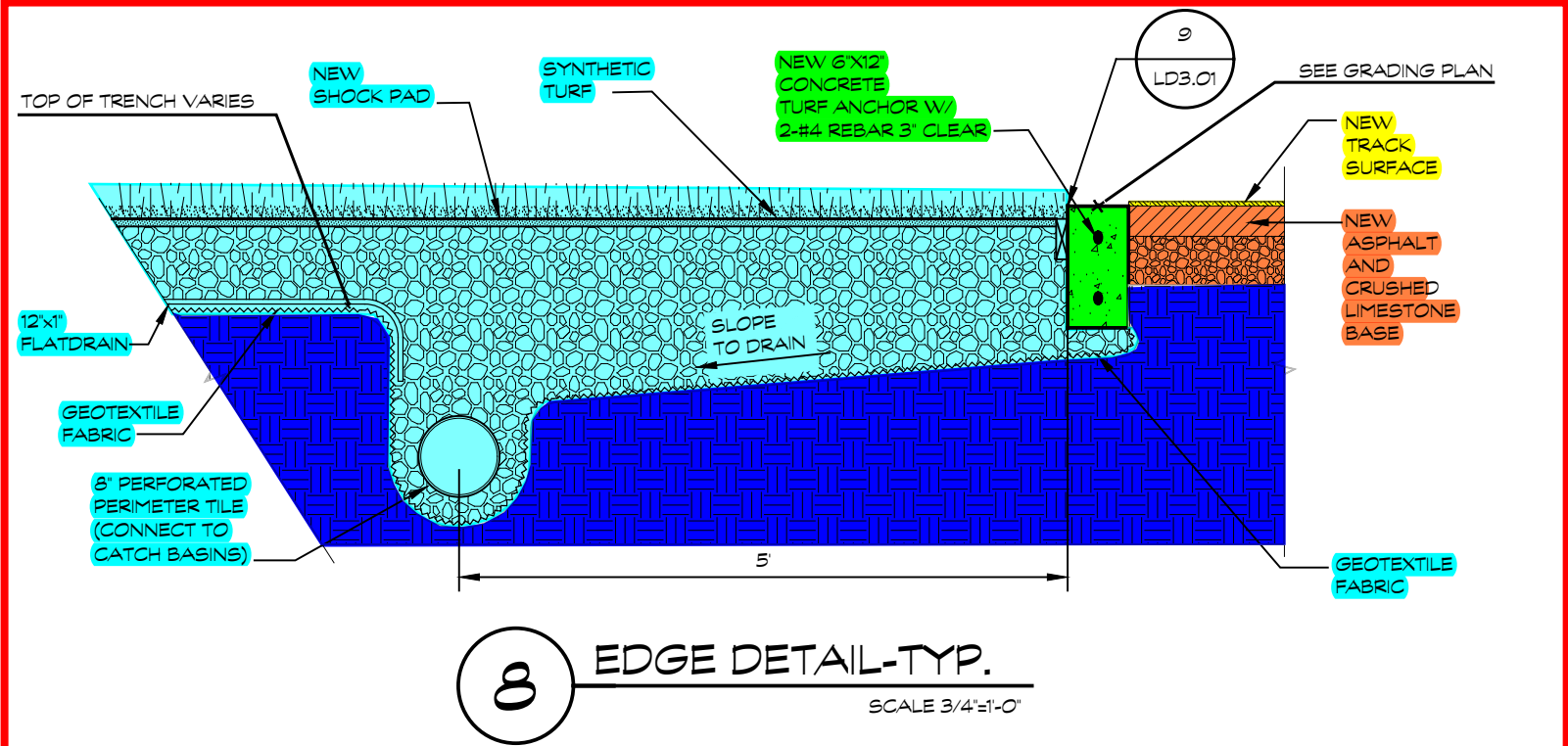

# Track and Turf Grading Delineation Example

- 31A - Grade site
- 32A - Furnish, grade and compact stone base for track
- 32B - Furnish, grade and compact stone for turf areas

# Attachment A

# Baseball / Softball Delineation Example #2

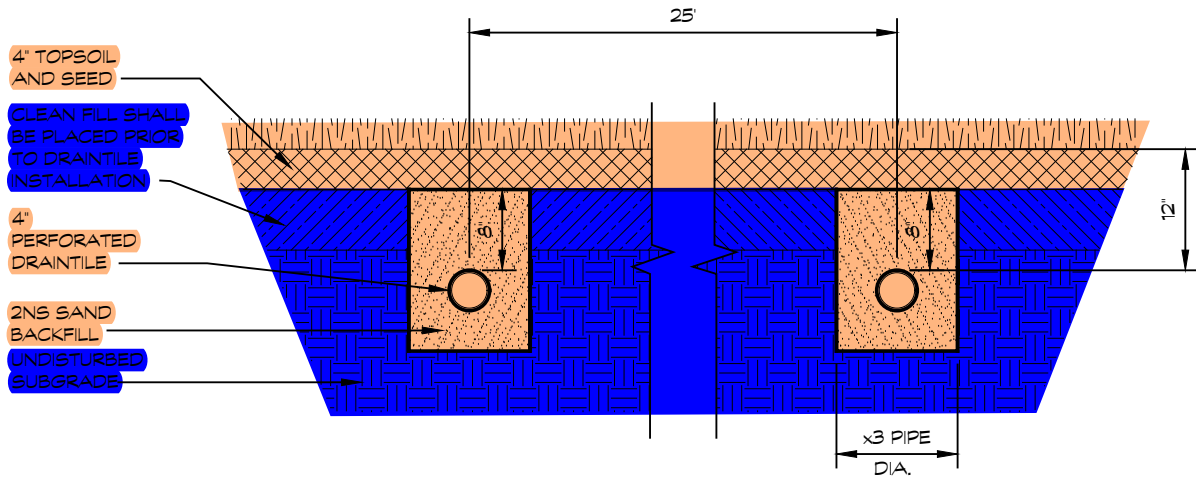

**13** 4" DRAINTILE SECTION  
SCALE 3/4"=1'-0"

- 31A - Site work
- 32A - Asphalt
- 03 - Concrete
- 32B - Turf
- 32C - Track Surface
- 32F - Landscaping
- 31B - Ball Field Sitework
- 32D - Tennis Court Surfacing

---

SECTION 002416  
SCOPE OF WORK  
BID CATEGORY SPECIFIC NOTES

**BID CATEGORY 02-UST System Removal**

GENERAL – The following shall not be interpreted as a complete itemization of the work to be performed under this Bid Category. This Bid Category Trade Contractor shall be responsible to perform all work reasonably interpreted to be included in its scope of work in accordance with the drawings and specifications in addition to these Bid Category notes of clarification.

**BASE SPECIFICATION(S)**

Include **ALL WORK** specified or reasonably inferred

002413 – SCOPE OF WORK GENERAL NOTES

026500 – UST SYSTEM REMOVAL

**PARTIAL SCOPE OF WORK / REFERENCE SPECIFICATION(S)**

Include **PORTIONS** of the Work specified and/or requirements as it pertain to the work of this Bid Category.

015000 – TEMPORARY FACILITIES AND CONTROLS

312000 – EARTH MOVING

321124 – AGGREGATE BASE COURSE

Include (Furnish and Install u.n.o):

1. Pumping of water to accomplish the Work of this bid category.
2. Maintain streets and public areas free of dirt, mud and debris. Daily or more frequent road sweeping as required when debris is tracked onto roads.
3. Determine location of existing underground utilities prior to any excavation work. Contact MISS DIG a minimum of 3 days in advance of any excavation work, more than 3 days if required to allow adequate time for MISS DIG to mark underground utilities as required to meet excavation work schedules. Submit verification of MISS DIG work order to Clark Construction Company. Hand dig as necessary to avoid contact with underground utilities.
4. ~~Determine location of existing underground utilities prior to any excavation work outside of the responsibility of MISS DIG for marking including fiber optic lines and other non-public utilities.~~
5. Protect existing structures, equipment, trees, landscaping, etc., to remain.
6. Dust control for the duration of this work.
7. Remove debris from the site in a timely manner.
8. Legal disposal of materials off site.
9. Excavation and backfill associated with the work.

---

SECTION 002416  
SCOPE OF WORK  
BID CATEGORY SPECIFIC NOTES

10. Barricades Traffic Maintenance and Control in accordance with Section 015000 – temporary Facilities and Controls.
11. Coordinate, accomplish, verify and provide evidence of utility shut downs and/or disconnects.
12. Obtain permits, fees and licenses required to complete the work of this bid category from governing authorities and provide evidence of same to Construction Manager.
13. Provide certified flag personnel, signage and all other miscellaneous appurtenances required for traffic and pedestrian control while delivering to the job site. All equipment, trucks and vehicles entering and/or exiting the jobsite must be accompanied by certified flag personnel. The construction gates must be kept always closed unless a full-time certified flag person is assigned and stationed at the opened gate.
14. Remove above ground, overhead and below grade materials (e.g. pavement and base material, utilities, etc.) indicated in the documents.
15. Import and export of soils required to accomplish the work of this bid category.
16. Coordinate all work and testing with environmental consultant.
17. Include all backfill once removal is completed per note 17 on C2.5.
  - a. Include Allowance of 600 CY of sand backfill per note 17.
18. Include removal of asphalt in area shown in Note 17 on C2.5.
19. Include 150 cubic yard allowance per RFI-219. Include all direction and assumptions per RFI-219 as issued in Addendum 002.



---

SECTION 002416  
SCOPE OF WORK  
BID CATEGORY SPECIFIC NOTES

**BID CATEGORY 31A - SITE DEMO, MASS GRADING, SOIL EROSION CONTROL AND UNDERGROUND UTILITIES**

GENERAL – The following shall not be interpreted as a complete itemization of the work to be performed under this Bid Category. This Bid Category Trade Contractor shall be responsible to perform all work reasonably interpreted to be included in its scope of work in accordance with the drawings and specifications in addition to these Bid Category notes of clarification.

**BASE SPECIFICATION** - (Include **all** Work specified or reasonably inferred)

**002413 – SCOPE OF WORK GENERAL NOTES**

024119 – SELECTIVE DEMOLITION  
311000 – SITE CLEARING  
311012 – FINE GRADING  
311018 – SOIL EROSION CONTROL  
312000 – EARTH MOVING  
312010 – EARTHWORK – ATHLETICS  
313219 – GEOTEXTILE FABRIC  
321123 – AGGREGATE DRAINAGE LAYER  
321124 – AGGREGATE BASE COURSE  
330507 – DIRECTIONAL DRILL WATER MAIN  
331100 – WATER MAIN  
333100 – SANITARY SEWERS  
334100 – STORM SEWERS – UNDERDRAINAGE-DRAINAGE SYSTEM  
334125 – UTILITY SLEEVES

**REFERENCE SPECIFICATION** - (Include portions of the Work specified as noted below)

015000 – Temporary Facilities and Controls  
026500 – UST SYSTEM REMOVAL

**SITWORK AND GRADING**

Include (Furnish and Install u.n.o):

1. Verify on-site and surrounding grades are in accordance with the Documents prior to start of the work. Report discrepancies to Clark Construction Company in writing.



---

SECTION 002416

SCOPE OF WORK

BID CATEGORY SPECIFIC NOTES

2. Verify location of existing utilities prior to performing the work. Hand dig as required to avoid contact with underground utilities.
3. Maintain streets and public areas free of dirt, mud and debris. Daily or more frequent road sweeping as required when debris is tracked onto roads.
4. Remove debris and/or spoils from the site in a timely manner.
5. Import and export of soil material, cut and fill, grading, and compaction to achieve grades required by the documents.
6. Site grading to plus or minus 1/10 of a foot of design.
7. Pumping water to perform the work of this bid category.
8. Legal disposal of materials off site.
9. Provide erosion control for entire project, including soil permit, installation, maintenance, storm water operator and removal at completion of project.
10. Tree removal, clearing and grubbing.
11. Protect existing structures and/or trees and landscaping to remain.
12. Construct building pad including import material, placement, grading, and compaction.
13. Strip and stockpile topsoil and coordinate stockpile location with Clark Construction Company.
14. Grade, seed and mulch areas disturbed outside of construction limits as a result of the work of this bid category.
15. Proof rolling of sub-grade as required prior to placement of stone base, asphalt, concrete or other materials.
16. Placing and fine grading sand required between rough grade subbase and finished surfaces such as asphalt and concrete. See details below for grading direction for athletics, storage building and parking lots. See scope delineation for placement of granular base material.
17. Saw cut and removal of existing curb sections may be required for ingress and egress.
18. Furnish and install Rip-Rap at concrete spillways per C5.1. See RFI-245.

Exclude:

1. Stone base for football field, aux field, including track. See Delineation of base material below.

**SOIL EROSION CONTROL**

Include (Furnish and Install u.n.o):

1. Submit soil erosion control plan to governing authorities and secure all permits.
2. Furnish, install, maintain and inspect as required all soil erosion control including all existing storm structure and storm system sedimentation guards as required in

---

SECTION 002416

SCOPE OF WORK

BID CATEGORY SPECIFIC NOTES

- accordance with the Documents and requirements of authorities having jurisdiction.
3. Remove soil erosion control after permanent vegetation is established and approved by governing authorities and as directed by Clark Construction Company.
  4. Maintain Streets and public areas free of dirt, mud and debris. Daily or more frequent road sweeping as required when debris is tracked onto roads.
  5. Protect existing structures and/or trees and landscaping to remain.
  6. Provide soil erosion system inspections by a certified storm water operator as required by authorities having jurisdiction.

**SITE UTILITIES**

Include (Furnish and Install u.n.o):

7. Verify location of existing utilities prior to performing the Work. Hand dig as required to avoid contact with underground utilities. Report location, invert elevation discrepancies or interferences to Clark Construction Company in writing.
8. Verify existing grade prior to performing the Work. Report discrepancies to Clark Construction Company in writing.
9. Excavation, backfill and compaction associated with the Work of this bid category.
10. Remove spoils and debris from the site in a timely manner.
11. Pumping water to accomplish the Work of this bid category.
12. Perform water, sanitary and storm tie-in to public utility system in accordance with requirements of authorities having jurisdiction.
13. Extend utility piping to connect to building systems to 5'-0" from the building line. Coordinate with building Trade Contractors and other design documents the exact location and elevation of connection prior to performing the Work. Report discrepancies to Clark Construction Company in writing.
14. Install drainage structures such that Subgrade will drain completely by gravity. Final adjustments of the drainage structures shall be performed by this bid category at a later date just prior to placement of finished surfaces and as directed by Clark Construction Company. Final adjustments shall include required excavation, backfill and compaction.
15. Coordinate and perform final adjustments of valve boxes and other utilities prior to placement of finished surfaces by others.
16. Dust control for the duration of the Work of this bid category.
17. Restore disturbed grade to condition that existed prior to performing the Work.
18. Obtain permits required to complete the Work of this bid category.
19. Protect existing structures and/or trees and landscaping to remain.
20. Import and export of soils required to accomplish the Work of this bid category.

---

SECTION 002416  
SCOPE OF WORK  
BID CATEGORY SPECIFIC NOTES

21. Final connection to building utilities  $\pm$  5'-0" from the building line.
22. Underdrain system.
23. Grade, seed and mulch areas disturbed outside of the building area as a result of the Work of this bid category.
24. Clean dirt and debris out of storm water system upon completion of the project when directed by Clark Construction Company.
25. Mechanical Trade Contractor will perform utility connections 5'-0" outside building line.
26. Include all work associated with the Phasing Plan listed on C1.1 and C1.2. This includes temporary utilities, temporary structures and detention ponds to facilitate County requirements. Removal of all temporary utilities upon completion of phasing.

### SITE DEMOLITION

Include (Furnish and Install u.n.o):

1. Pumping of water to accomplish the Work of this bid category.
2. Maintain streets and public areas free of dirt, mud and debris. Daily or more frequent road sweeping as required when debris is tracked onto roads.
3. Determine location of existing underground utilities prior to any excavation work. Contact MISS DIG a minimum of 3 days in advance of any excavation work, more than 3 days if required to allow adequate time for MISS DIG to mark underground utilities as required to meet excavation work schedules. Submit verification of MISS DIG work order to Clark Construction Company. Hand dig as necessary to avoid contact with underground utilities.
4. Determine location of existing underground utilities prior to any excavation work outside of the responsibility of MISS DIG for marking including fiber optic lines and other non-public utilities. See allowances below for identification of private utilities.
5. Protect existing structures, equipment, trees, landscaping, etc., to remain.
6. Dust control for the duration of this work.
7. Remove debris from the site in a timely manner.
8. Legal disposal of materials off site.
9. Excavation and backfill associated with the work
10. Barricades Traffic Maintenance and Control in accordance with Section 015000 – temporary Facilities and Controls.
11. Obtain and pay for all permits and fees associated with the Work of this bid category and provide evidence of same to Construction Manager.
12. Coordinate, accomplish, verify and provide evidence of utility shut downs and/or disconnects.
13. Tree removal, clearing and grubbing.
14. Provide certified flag personnel, signage and all other miscellaneous appurtenances required for traffic and pedestrian control while delivering to the

---

SECTION 002416

SCOPE OF WORK

BID CATEGORY SPECIFIC NOTES

- job site. All equipment, trucks and vehicles entering and/or exiting the jobsite must be accompanied by certified flag personnel. The construction gates must be kept always closed unless a full-time certified flag person is assigned and stationed at the opened gate.
15. Remove above ground, overhead and below grade materials (e.g. pavement and base material, utilities, etc.) indicated in the documents.
  16. Import and export of soils required to accomplish the work of this bid category.
  17. Overhead and underground utility cutting, capping, valves, etc., as required to accomplish the work and as required by authorities having jurisdiction.
  18. Coordinate turnover of material to be salvaged with Clark Construction Company.
  19. Saw cutting and removal of existing curbs may be required for ingress and egress.
  20. Include all site demolition, including bleachers, miscellaneous structures, etc. All demolition is to be completed by this bid category.
  21. Remove and existing frost slab shown on C4.6.

Exclude:

1. UST System removal including pavement removal per listed in on note \_ C2.5.
2. Backfill associated with UST System removal. Note 17 on C2.5 is to be done by Bid Category 02.

**TEMPORARY ROADS & STAGING AREA**

Include (Furnish and Install u.n.o):

1. Provide temporary staging area 1,000 square foot in location directed by Clark Construction Company. Cross section shall be a 6" layer of one-to-three-inch size crushed concrete or crushed limestone topped with 6" 21AA crushed concrete or limestone layer. Remove when directed by Clark Construction Company.
2. Provide temporary stone access road 20'-0 x 250'-0 cross section shall be an 8" layer of one-to-three-inch size crushed concrete or crushed limestone topped with 6" 21AA crushed concrete or limestone layer. Remove when directed by Clark Construction Company.
3. Obtain and pay for all permits and fees associated with the Work of this bid category and provide evidence of same to Construction Manager.
4. Basic benchmarks and control lines will be provided. Trade Contractor shall be responsible for all other engineering and layout required for the performance of its Work.
5. Provide certified flag personnel, signage and all other miscellaneous appurtenances required for traffic and pedestrian control while delivering to the job site. All equipment, trucks and vehicles entering and/or exiting the jobsite must be accompanied by certified flag personnel. The construction gates must be kept always closed unless a full-time certified flag person is assigned and stationed at the opened gate.

---

SECTION 002416  
SCOPE OF WORK  
BID CATEGORY SPECIFIC NOTES

6. Temporary water source as required to perform the work of this category.
7. Maintain temporary road and temporary staging areas. Include an allowance of 80 hours for equipment and operator in base bid for this item. Work tickets signed by Clark Construction Company shall be provided to document hours used. A deduct change order will be issued for any unused portion of this allowance.
8. Removal of stone and final grading when directed by Clark Construction Company.

Summary of Allowances

1. **Allowance No. 1** : An allowance of 1,000 cubic yards for undercutting subbase material. Allowance shall be based on volume of material removed and shall include all labor, material equipment, import and export of material. Work tickets signed by Clark Construction Company shall be provided to document quantities. A deduct change order will be issued for any unused portion of this allowance. See specification 012100 – Allowances for more information. Parking Lot.
2. **Allowance No. 2**: An allowance of 1,000 cubic yards for undercutting subbase material. Allowance shall be based on volume of material removed and shall include all labor, material equipment, import and export of material. Work tickets signed by Clark Construction Company shall be provided to document quantities. A deduct change order will be issued for any unused portion of this allowance. See specification 012100 – Allowances for more information. Athletic Fields.
3. **Allowance 3** : Include an allowance of \$10,000 for snow fencing.
4. **Allowance 4** : Include an allowance of \$50,000 for permit requirements.
5. **Allowance 5**: Include an allowance of \$100,000 for removal or existing stockpile
6. **Allowance 6** : Include an allowance of \$10,000 for exploratory excavation per RFI-238.
7. **Allowance 7** : Include an allowance of \$10,000 for location of private utilities.

\*\* SEE ATTACHMENT A for breakdown of scope.

---

SECTION 002416  
SCOPE OF WORK  
BID CATEGORY SPECIFIC NOTES

**BID CATEGORY 32A-Asphalt Paving**

GENERAL – The following shall not be interpreted as a complete itemization of the work to be performed under this Bid Category. This Bid Category Trade Contractor shall be responsible to perform all work reasonably interpreted to be included in its scope of work in accordance with the drawings and specifications in addition to these Bid Category notes of clarification.

**BASE SPECIFICATION** - (Include **all** Work specified or reasonably inferred)

**002413 – SCOPE OF WORK GENERAL NOTES**

311012 – FINE GRADING  
321216 – HOT-MIX ASPHALT CONCRETE PAVING  
321217 – HOT-MIX ASPHALT – RUNNING TRACK  
321415 – PAVEMENT MARKINGS

**REFERENCE SPECIFICATION** - (Include portions of the Work specified as noted below)

015000 – Temporary Facilities and Controls  
321124 – AGGREGATE BASE COURSE  
321826 ALL-WEATHER SYNTHETIC TRACK SURFACE

**Include (Furnish and Install u.n.o):**

1. Verify Contract Document asphalt design will provide positive drainage in all areas prior to performing the work. Report potential problem areas to Clark Construction Company in writing.
2. Verify existing grade elevations prior to performing the work. Report discrepancies to Clark Construction Company in writing.
3. Maintain streets and public areas free of dirt, mud and debris. Daily or more frequent road sweeping as required when debris is tracked onto roads.
4. Coordinate adjustment of all storm catch basins, manhole covers, valve boxes, etc. with other Trades prior to beginning the work.
5. Proof roll sub-grade prior to placement of stone base.
6. Fine grading of subbase material.
7. Furnish, place and grade stone base material. See detail below for delineation of furnish, placement and grading of stone base material.
8. Finished asphalt shall have positive drainage over the entire surface.
9. Pavement markings.
10. Furnish and install site signage. See C5.1 for detail.
11. Furnish and install wayfinding signs.

---

SECTION 002416  
SCOPE OF WORK  
BID CATEGORY SPECIFIC NOTES

12. Water test athletic surfaces upon completion of the work. Water ponding shall not be greater than 1/8" depth X 1'-0" diameter. Not more than two such areas shall be allowed over 2500 SF.
13. Asphalt paving contractor shall power-wash asphalt prior to installation of all-weather track surface. Contractor shall flood the asphalt to identify all potential "Bird Bath" areas prior to surface application. Bird bath areas will be repaired as directed by the Landscape Architect.
14. Maintain streets and public areas free of dirt, mud and debris. Daily or more frequent road sweeping as required when debris is tracked onto roads.
15. Multiple mobilizations will be required per the phasing schedule. See milestone schedule for phasing.
16. Milling existing asphalt as indicated.
17. An allowance of 250 cubic yards for undercutting subbase material. Allowance shall be based on loose volume of material removed. Allowance shall include all labor, material and equipment, export of spoils, import placement and compaction of approved fill material. Work tickets signed by Clark Construction Company shall be provided to document quantities. A deduct change order will be issued for any unused portion of this allowance.
18. A separate mobilization will be required to place top course for main drive North/South connecting Weber-Blaessor to Thibault Ln and pathway going East to end of Phase 1. This pathway is to be used for construction traffic and access to the site. Include an allowance of \$15,000 for removal and repair of base asphalt areas prior to placement of top course.
19. Furnish, place and grade stone base material for track.
20. Fine grade stone for new drives to athletics.
21. Fine grade stone base for parking lot asphalt.

\*\*SEE ATTACHMENT A for sitework scope breakdown.

**Date:** November 27, 2024  
**Name of Job:** Saline Middle School Rec Complex  
**Owner of Job:** Saline Area Schools  
**Location:** 7190 N. Maple Rd. Saline, MI 48176  
**A/E #:** 2900.09B DF

## **ADDENDUM No. 2**

### **SPECIAL NOTE:**

The Notice to Bidders, Instructions to Bidders, General Conditions of the Contract for Construction, Supplementary Conditions of the Contract for Construction, and all modifications and previously issued Contract Documentation are a part of this Addendum.

### **SCOPE OF WORK:**

The following items are changes, additions, deletions, clarifications and/or errors and omissions in plans & specifications and shall be considered by each Bidder in making up and submitting their proposal. All items shall be considered a part of the Contract Documents.

### **NOTICE TO ALL BIDDERS:**

All Bidders shall take note of all items covered by this Addendum. Each Bidder shall review the total scope of his responsibilities with respect to his contract work and his interface with the work of others, as well as his required interface with their work.

### **ATTACHMENTS:**

Specifications: Table of Contents  
Drawings: G0.1, C1.0, M1.1.

### **SPECIFICATIONS:**

Table of Contents  
Removed section 116833 Athletic Field Equipment  
Added section 107516 Flagpoles

### **DRAWINGS:**

- Item No. 1.** Refer to sheet M1.1 (re-issued):
- A. Added details lines and dimensions to clarify intent for new PTAC in existing Concessions Building storage room.
  - B. Modified notes to clarify intent for new PTAC in existing Concessions Building storage room.
- Item No. 2.** Refer to sheet G0.1 & C1.0 (re-issued):
- A. Revised sheet list to reflect sheets issued.

### **END OF ADDENDUM**



## TABLE OF CONTENTS

### **DIVISION 00 – PROCUREMENT AND CONTRACTING REQUIREMENTS**

003132 GEOTECHNICAL DATA

### **DIVISION 01 – GENERAL REQUIREMENTS**

012100 ALLOWANCES  
012200 UNIT PRICES  
012300 ALTERNATES  
013300 ARCHITECT’S SUBMITTAL PROCEDURES

### **DIVISION 02 – EXISTING CONDITIONS**

024119 SELECTIVE DEMOLITION  
026500 UST SYTEM REMOVAL

### **DIVISION 03 – CONCRETE**

033000 CAST-IN-PLACE CONCRETE  
033053 CONCRETE TURF ANCHOR  
033800 POST-TENSIONED CONCRETE

### **DIVISION 04 – MASONRY**

042000 UNIT MASONRY  
042300 GLASS UNIT MASONRY  
047200 CAST STONE MASONRY

### **DIVISION 05 – METALS**

055000 METAL FABRICATIONS

### **DIVISION 06 – WOOD, PLASTICS AND COMPOSITES**

061053 MISCELLANEOUS CARPENTRY  
061050 TURF WOOD NAILER  
061600 SHEATHING  
061753 SHOP-FABRICATED WOOD TRUSSES

### **DIVISION 07 – THERMAL AND MOISTURE PROTECTION**

072100 THERMAL INSULATION  
073113 ASPHALT SHINGLES  
074293 SOFFIT PANELS  
077100 ROOF SPECIALTIES  
079200 JOINT SEALANTS

### **DIVISION 08 – OPENINGS**

081743 FRP FLUSH DOORS AND FRAMES  
083613 SECTIONAL DOORS  
087100 DOOR HARDWARE  
089119 FIXED LOUVERS

**DIVISION 09 – FINISHES**

|        |                                |
|--------|--------------------------------|
| 092216 | NON-STRUCTURAL METAL FRAMING   |
| 092900 | GYPSUM BOARD                   |
| 095113 | ACOUSTICAL PANEL CEILINGS      |
| 096513 | RESILIENT BASE AND ACCESSORIES |
| 099600 | HIGH-PERFORMANCE COATINGS      |

**DIVISION 10 – SPECIALTIES**

|           |                                      |
|-----------|--------------------------------------|
| 101423.16 | ROOM-IDENTIFICATION PANEL SIGNAGE    |
| 101700    | FRP TOILET PARTITION SYSTEM          |
| 102800    | TOILET, BATH AND LAUNDRY ACCESSORIES |
| 104416    | FIRE EXTINGUISHERS                   |
| 107516    | FLAGPOLES                            |

**DIVISION 11 – EQUIPMENT**

|        |                             |
|--------|-----------------------------|
| 116826 | NET TENSION SYSTEM          |
| 116830 | WINDSCREENS                 |
| 116833 | ATHLETIC FIELD EQUIPMENT    |
| 116834 | FOOTBALL GOAL POSTS         |
| 116836 | SOCCER & LACROSSE GOALS     |
| 116837 | SHADED DUGOUT STRUCTURE     |
| 116838 | BASEBALL/SOFTBALL EQUIPMENT |
| 116840 | FIELD EVENT CONSTRUCTION    |
| 116842 | PROTECTIVE NETTING SYSTEM   |
| 116843 | SCOREBOARD                  |

**DIVISION 12 – FURNISHINGS**

|        |                |
|--------|----------------|
| 129305 | ALUMINUM BENCH |
|--------|----------------|

**DIVISION 13 – SPECIAL CONSTRUCTION**

|        |                          |
|--------|--------------------------|
| 133400 | PRECAST CONCRETE DUGOUTS |
| 133420 | METAL SHELTER            |
| 133423 | PRESSBOX                 |
| 133520 | GRANDSTAND               |

**DIVISION 14 THRU 21**

(NOT USED)

**DIVISION 22 – PLUMBING**

|        |  |
|--------|--|
| 220005 | BASIC PLUMBING REQUIREMENTS                      |
| 220517 | SLEEVES AND SLEEVE SEALS FOR PLUMBING PIPING     |
| 220519 | METERS AND GAUGES FOR PLUMBING PIPING            |
| 220523 | GENERAL-DUTY VALVES FOR PLUMBING PIPING          |
| 220553 | IDENTIFICATION FOR PLUMBING PIPING AND EQUIPMENT |
| 220719 | PLUMBING PIPING INSULATION                       |
| 221005 | PLUMBING PIPING                                  |
| 221006 | PLUMBING PIPING SPECIALTIES                      |
| 221123 | DOMESTIC WATER PUMPS                             |
| 223000 | PLUMBING EQUIPMENT                               |
| 224000 | PLUMBING FIXTURES                                |

**DIVISION 23 – HEATING, VENTILATING AND AIR CONDITIONING**

|        |   |
|--------|---|
| 230005 | BASIC HVAC REQUIREMENTS                               |
| 230553 | IDENTIFICATION FOR HVAC PIPING AND EQUIPMENT          |
| 230593 | TESTING, ADJUSTING, AND BALANCING FOR HVAC & PLUMBING |
| 230913 | INSTRUMENTATION AND CONTROL DEVICES FOR HVAC          |
| 230925 | DIRECT-DIGITAL CONTROL (DDC) SYSTEMS FOR HVAC         |
| 233100 | HVAC DUCTS AND CASINGS                                |
| 233300 | AIR DUCT ACCESSORIES                                  |
| 233423 | HVAC POWER VENTILATORS                                |
| 233700 | AIR OUTLETS AND INLETS                                |
| 238113 | PACKAGED TERMINAL AIR-CONDITIONERS                    |
| 238200 | CONVECTION HEATING AND COOLING UNITS                  |

**DIVISION 26 – ELECTRICAL**

|           |  |
|-----------|--|
| 260005    | BASIC ELECTRICAL REQUIREMENTS                      |
| 260505    | SELECTIVE DEMOLITION FOR ELECTRICAL                |
| 260519    | LOW-VOLTAGE ELECTRICAL POWER CONDUCTORS AND CABLES |
| 260526    | GROUNDING AND BONDING FOR ELECTRICAL SYSTEMS       |
| 260529    | HANGERS AND SUPPORTS FOR ELECTRICAL SYSTEMS        |
| 260533.13 | CONDUIT FOR ELECTRICAL SYSTEMS                     |
| 260533.16 | BOXES FOR ELECTRICAL SYSTEMS                       |
| 260553    | IDENTIFICATION FOR ELECTRICAL SYSTEMS              |
| 260573    | POWER SYSTEM STUDIES                               |
| 260935    | DISTRIBUTED DIGITAL LIGHTING CONTROL SYSTEM        |
| 262200    | LOW-VOLTAGE TRANSFORMERS                           |
| 262416    | PANELBOARDS  |
| 262726    | WIRING DEVICES                                     |
| 262816.16 | ENCLOSED SWITCHES                                  |
| 264300    | SURGE PROTECTIVE DEVICES                           |
| 265100    | INTERIOR LIGHTING                                  |
| 265600    | EXTERIOR LIGHTING                                  |
| 265668    | EXTERIOR ATHLETIC LIGHTING                         |

**DIVISION 27 - COMMUNICATIONS**

|        |                     |
|--------|---------------------|
| 275119 | FIELD UTILITY BOXES |
|--------|---------------------|

**DIVISION 28**

(NOT USED)

**DIVISION 31 – EARTHWORK**

|        |                       |
|--------|-----------------------|
| 311000 | SITE CLEARING         |
| 311012 | FINE GRADING          |
| 311018 | SOIL EROSION CONTROL  |
| 312000 | EARTH MOVING          |
| 312010 | EARTHWORK – ATHLETICS |
| 313219 | GEOTEXTILE FABRIC     |

**DIVISION 32 – EXTERIOR IMPROVEMENTS**

|        |                          |
|--------|--------------------------|
| 321123 | AGGREGATE DRAINAGE LAYER |
| 321124 | AGGREGATE BASE COURSE    |

|         |  |
|---------|--|
| 321216  | HOT-MIX ASPHALT CONCRETE PAVING              |
| 321217  | HOT-MIX ASPHALT – RUNNING TRACK              |
| 321313  | CEMENT CONCRETE PAVEMENTS, CURBS AND GUTTERS |
| 321373  | CONCRETE PAVING JOINT SEALANTS               |
| 321415  | PAVEMENT MARKINGS                            |
| 321724  | TRACK MARKINGS                               |
| 321818  | SYNTHETIC TURF                               |
| 321820  | INFIELD MIX                                  |
| 321826  | ALL-WEATHER SYNTHETIC TRACK SURFACE          |
| 321828  | LONG JUMP PIT SAND                           |
| 321831  | SHOT PUT MATERIAL                            |
| 328136  | ACRYLIC TENNIS COURT SURFACE                 |
| 321852  | PERFORMANCE SHOCK PAD                        |
| 323130  | CHAINLINK FENCE - VINYL                      |
| 328400  | UNDERGROUND IRRIGATION SYSTEM                |
| 329119  | TOPSOIL -- ATHLETICS                         |
| 329200  | TURF AND GRASSES                             |
| 329220  | TOPSOIL                                      |
| 329223  | LAWNS – ATHLETICS (SOD)                      |
| 32 9300 | LANDSCAPE PLANTING                           |
| 329400  | LANDSCAPE MAINTENANCE AND WARRANTY STANDARDS |

**DIVISION 33 – UTILITIES**

|         |  |
|---------|--|
| 33 0507 | DIRECTIONAL DRILL WATER MAIN               |
| 331100  | WATER MAIN                                 |
| 333100  | SANITARY SEWERS                            |
| 334100  | STORM SEWERS-UNDERDRAINAGE-DRAINAGE SYSTEM |
| 334125  | UTILITY SLEEVES                            |
| 334416  | UTILITY TRENCH DRAIN - ATHLETICS           |
| 334600  | SUBDRAINAGE SYSTEMS - SAND                 |
| 334605  | SUBDRAINAGE SYSTEMS -- PEASTONE            |
| 334615  | TURF DRAINTILE                             |



# MS REC COMPLEX SALINE AREA SCHOOLS



CONSTRUCTION DOCUMENTS  
OCTOBER 24, 2024

**MS REC COMPLEX**  
SALINE AREA SCHOOLS  
7190 N. Maple Rd. Saline, MI 48176



### DIRECTORY

#### CLIENT:

SALINE AREA SCHOOLS  
7265 N. ANN ARBOR ST.  
SALINE, MI, 48176  
(734) 401-4000

#### ARCHITECT & CIVIL ENGINEER:

KINGSCOTT ASSOCIATES INC.  
254 E MICHIGAN AVE, SUITE 308  
KALAMAZOO, MI 49007  
P. (800) 632-7615

#### CIVIL ENGINEER:

SFALDING DEDecker  
905 E. SOUTH BLVD.  
ROCHESTER, MI, 48307  
(248) 844-5400

#### STRUCTURAL ENGINEER:

ROBERT DARVAS ASSOCIATES  
440 S. MAIN ST.  
ANN ARBOR, MI, 48104  
(734) 761-8713

#### MEP ENGINEER:

SES ENGINEERS  
4000 WEST 11 MILE ROAD  
BERKLEY, MI 48072  
P. (248) 399-1900

#### ATHLETICS & PLAYGROUND:

FORESITE DESIGN INC  
3264 COOLIDGE HWY  
BERKLEY, MI, 48072  
(248) 541-7157

#### CONSTRUCTION MANAGER:

CLARK CONSTRUCTION CO.  
3535 MOORES RIVER DR.  
LANSING, MI, 48911  
(313) 372-0340

### SHEET INDEX:

|               |                                  |
|---------------|----------------------------------|
| GENERAL       | TITLE SHEET                      |
| G0.1          | DATA SHEET                       |
| G0.2          |                                  |
| CIVIL DEMO    | GENERAL PLAN                     |
| C1.0          | PHASING PLAN - (1 OF 2)          |
| C1.1          | PHASING PLAN - (2 OF 2)          |
| C2.0          | GENERAL DEMOLITION PLAN          |
| C2.1          | DEMOLITION PLAN AREA 1           |
| C2.2          | DEMOLITION PLAN AREA 2           |
| C2.3          | DEMOLITION PLAN AREA 3           |
| C2.4          | DEMOLITION PLAN AREA 4           |
| C2.5          | DEMOLITION PLAN AREA 5           |
| C2.6          | DEMOLITION PLAN AREA 6           |
| C2.7          | DEMOLITION PLAN AREA 7           |
| C2.8          | DEMOLITION PLAN AREA 8           |
| CIVIL UTILITY | GENERAL UTILITY PLAN             |
| C3.0          | UTILITY PLAN AREA 1              |
| C3.1          | UTILITY PLAN AREA 2              |
| C3.2          | UTILITY PLAN AREA 3              |
| C3.3          | UTILITY PLAN AREA 4              |
| C3.4          | UTILITY PLAN AREA 5              |
| C3.5          | UTILITY PLAN AREA 6              |
| C3.6          | UTILITY PLAN AREA 7              |
| C3.7          | UTILITY PLAN AREA 8              |
| C3.8          | UTILITY DETAILS                  |
| C3.9          | DETENTION DETAILS & CALCULATIONS |
| C3.10         | OPERATIONS & MAINTENANCE PLAN    |
| C3.11         | DRAINAGE AREA MAP - WEST         |
| C3.12         | DRAINAGE AREA MAP - EAST         |
| C3.13         | STORMWATER CALCULATIONS          |
| C3.14         | WATERMAIN PROFILES (1 OF 2)      |
| C3.15         | WATERMAIN PROFILES (2 OF 2)      |
| C3.16         | SANITARY PROFILE                 |
| C3.17         | STORMWATER PROFILES (1 OF 4)     |
| C3.18         | STORMWATER PROFILES (2 OF 4)     |
| C3.19         | STORMWATER PROFILES (3 OF 4)     |
| C3.20         | STORMWATER PROFILES (4 OF 4)     |
| CIVIL PAVING  | GENERAL PAVING PLAN              |
| C4.0          | PAVING PLAN AREA 1               |
| C4.1          | PAVING PLAN AREA 2               |
| C4.2          | PAVING PLAN AREA 3               |
| C4.3          | PAVING PLAN AREA 4               |
| C4.4          | PAVING PLAN AREA 5               |
| C4.5          | PAVING PLAN AREA 6               |
| C4.6          | PAVING PLAN AREA 7               |
| C4.7          | PAVING PLAN AREA 8               |
| C4.8          | PAVING DETAILS - (1 OF 2)        |
| C4.9          | PAVING DETAILS - (2 OF 2)        |

|               |  |
|---------------|--|
| CIVIL GRADING | GENERAL GRADING PLAN                               |
| G6.0          | GRADING PLAN AREA 1                                |
| G6.1          | GRADING PLAN AREA 2                                |
| G6.2          | GRADING PLAN AREA 3                                |
| G6.3          | GRADING PLAN AREA 4                                |
| G6.4          | GRADING PLAN AREA 5                                |
| G6.5          | GRADING PLAN AREA 6                                |
| G6.6          | GRADING PLAN AREA 7                                |
| G6.7          | GRADING PLAN AREA 8                                |
| G6.8          | GRADING PLAN AREA 9                                |
| CIVIL GRADING | SOIL EROSION AND SEDIMENTATION CONTROL PLAN        |
| G7.1          | SOIL EROSION AND SEDIMENTATION CONTROL DETAILS     |
| G7.2          |  |
| CIVIL TOPO    | TOPOGRAPHICAL SURVEY - (1 OF 15)                   |
| G8.1          | TOPOGRAPHICAL SURVEY - (2 OF 15)                   |
| G8.2          | TOPOGRAPHICAL SURVEY - (3 OF 15)                   |
| G8.3          | TOPOGRAPHICAL SURVEY - (4 OF 15)                   |
| G8.4          | TOPOGRAPHICAL SURVEY - (5 OF 15)                   |
| G8.5          | TOPOGRAPHICAL SURVEY - (6 OF 15)                   |
| G8.6          | TOPOGRAPHICAL SURVEY - (7 OF 15)                   |
| G8.7          | TOPOGRAPHICAL SURVEY - (8 OF 15)                   |
| G8.8          | TOPOGRAPHICAL SURVEY - (9 OF 15)                   |
| G8.9          | TOPOGRAPHICAL SURVEY - (10 OF 15)                  |
| G8.10         | TOPOGRAPHICAL SURVEY - (11 OF 15)                  |
| G8.11         | TOPOGRAPHICAL SURVEY - (12 OF 15)                  |
| G8.12         | TOPOGRAPHICAL SURVEY - (13 OF 15)                  |
| G8.13         | TOPOGRAPHICAL SURVEY - (14 OF 15)                  |
| G8.14         | TOPOGRAPHICAL SURVEY - (15 OF 15)                  |
| G8.15         |  |
| CIVIL AGENCY  | CITY OF SALINE WATER MAIN STANDARD DETAILS W-1     |
| Q1.1          | CITY OF SALINE WATER MAIN STANDARD DETAILS W-2     |
| Q1.2          | CITY OF SALINE WATER MAIN STANDARD DETAILS W-3     |
| Q1.3          | CITY OF SALINE WATER MAIN STANDARD DETAILS W-4     |
| Q1.4          | CITY OF SALINE SANITARY SEWER STANDARD DETAILS S-1 |
| Q1.5          | CITY OF SALINE SANITARY SEWER STANDARD DETAILS S-1 |
| Q1.6          | CITY OF SALINE PAVEMENT STANDARD DETAILS P-1       |
| Q1.7          |  |
| Q1.8          |  |
| Q1.9          |  |
| Q1.10         |  |
| Q1.11         |  |
| Q1.12         |  |
| Q1.13         |  |
| Q1.14         |  |
| Q1.15         |  |
| Q1.16         |  |
| Q1.17         |  |
| Q1.18         |  |
| Q1.19         |  |
| Q1.20         |  |
| Q1.21         |  |
| Q1.22         |  |
| Q1.23         |  |
| Q1.24         |  |
| Q1.25         |  |
| Q1.26         |  |
| Q1.27         |  |
| Q1.28         |  |
| Q1.29         |  |
| Q1.30         |  |
| Q1.31         |  |
| Q1.32         |  |
| Q1.33         |  |
| Q1.34         |  |
| Q1.35         |  |
| Q1.36         |  |
| Q1.37         |  |
| Q1.38         |  |
| Q1.39         |  |
| Q1.40         |  |
| Q1.41         |  |
| Q1.42         |  |
| Q1.43         |  |
| Q1.44         |  |
| Q1.45         |  |
| Q1.46         |  |
| Q1.47         |  |
| Q1.48         |  |
| Q1.49         |  |
| Q1.50         |  |
| Q1.51         |  |
| Q1.52         |  |
| Q1.53         |  |
| Q1.54         |  |
| Q1.55         |  |
| Q1.56         |  |
| Q1.57         |  |
| Q1.58         |  |
| Q1.59         |  |
| Q1.60         |  |
| Q1.61         |  |
| Q1.62         |  |
| Q1.63         |  |
| Q1.64         |  |
| Q1.65         |  |
| Q1.66         |  |
| Q1.67         |  |
| Q1.68         |  |
| Q1.69         |  |
| Q1.70         |  |
| Q1.71         |  |
| Q1.72         |  |
| Q1.73         |  |
| Q1.74         |  |
| Q1.75         |  |
| Q1.76         |  |
| Q1.77         |  |
| Q1.78         |  |
| Q1.79         |  |
| Q1.80         |  |
| Q1.81         |  |
| Q1.82         |  |
| Q1.83         |  |
| Q1.84         |  |
| Q1.85         |  |
| Q1.86         |  |
| Q1.87         |  |
| Q1.88         |  |
| Q1.89         |  |
| Q1.90         |  |
| Q1.91         |  |
| Q1.92         |  |
| Q1.93         |  |
| Q1.94         |  |
| Q1.95         |  |
| Q1.96         |  |
| Q1.97         |  |
| Q1.98         |  |
| Q1.99         |  |
| Q1.100        |  |

|           |                       |
|-----------|-----------------------|
| ATHLETICS | OVERALL SITE PLAN     |
| L0.1      | TENNIS SITE PLAN      |
| L1.01     | TENNIS DIMENSION PLAN |
| L1.02     | TENNIS DIMENSION PLAN |
| L1.03     | TENNIS DIMENSION PLAN |
| L1.04     | TENNIS DIMENSION PLAN |
| L1.05     | TENNIS DIMENSION PLAN |
| L1.06     | TENNIS DIMENSION PLAN |
| L1.07     | TENNIS DIMENSION PLAN |
| L1.08     | TENNIS DIMENSION PLAN |
| L1.09     | TENNIS DIMENSION PLAN |
| L1.10     | TENNIS DIMENSION PLAN |
| L1.11     | TENNIS DIMENSION PLAN |
| L1.12     | TENNIS DIMENSION PLAN |
| L1.13     | TENNIS DIMENSION PLAN |
| L1.14     | TENNIS DIMENSION PLAN |
| L1.15     | TENNIS DIMENSION PLAN |
| L1.16     | TENNIS DIMENSION PLAN |
| L1.17     | TENNIS DIMENSION PLAN |
| L1.18     | TENNIS DIMENSION PLAN |
| L1.19     | TENNIS DIMENSION PLAN |
| L1.20     | TENNIS DIMENSION PLAN |
| L1.21     | TENNIS DIMENSION PLAN |
| L1.22     | TENNIS DIMENSION PLAN |
| L1.23     | TENNIS DIMENSION PLAN |
| L1.24     | TENNIS DIMENSION PLAN |
| L1.25     | TENNIS DIMENSION PLAN |
| L1.26     | TENNIS DIMENSION PLAN |
| L1.27     | TENNIS DIMENSION PLAN |
| L1.28     | TENNIS DIMENSION PLAN |
| L1.29     | TENNIS DIMENSION PLAN |
| L1.30     | TENNIS DIMENSION PLAN |
| L1.31     | TENNIS DIMENSION PLAN |
| L1.32     | TENNIS DIMENSION PLAN |
| L1.33     | TENNIS DIMENSION PLAN |
| L1.34     | TENNIS DIMENSION PLAN |
| L1.35     | TENNIS DIMENSION PLAN |
| L1.36     | TENNIS DIMENSION PLAN |
| L1.37     | TENNIS DIMENSION PLAN |
| L1.38     | TENNIS DIMENSION PLAN |
| L1.39     | TENNIS DIMENSION PLAN |
| L1.40     | TENNIS DIMENSION PLAN |
| L1.41     | TENNIS DIMENSION PLAN |
| L1.42     | TENNIS DIMENSION PLAN |
| L1.43     | TENNIS DIMENSION PLAN |
| L1.44     | TENNIS DIMENSION PLAN |
| L1.45     | TENNIS DIMENSION PLAN |
| L1.46     | TENNIS DIMENSION PLAN |
| L1.47     | TENNIS DIMENSION PLAN |
| L1.48     | TENNIS DIMENSION PLAN |
| L1.49     | TENNIS DIMENSION PLAN |
| L1.50     | TENNIS DIMENSION PLAN |
| L1.51     | TENNIS DIMENSION PLAN |
| L1.52     | TENNIS DIMENSION PLAN |
| L1.53     | TENNIS DIMENSION PLAN |
| L1.54     | TENNIS DIMENSION PLAN |
| L1.55     | TENNIS DIMENSION PLAN |
| L1.56     | TENNIS DIMENSION PLAN |
| L1.57     | TENNIS DIMENSION PLAN |
| L1.58     | TENNIS DIMENSION PLAN |
| L1.59     | TENNIS DIMENSION PLAN |
| L1.60     | TENNIS DIMENSION PLAN |
| L1.61     | TENNIS DIMENSION PLAN |
| L1.62     | TENNIS DIMENSION PLAN |
| L1.63     | TENNIS DIMENSION PLAN |
| L1.64     | TENNIS DIMENSION PLAN |
| L1.65     | TENNIS DIMENSION PLAN |
| L1.66     | TENNIS DIMENSION PLAN |
| L1.67     | TENNIS DIMENSION PLAN |
| L1.68     | TENNIS DIMENSION PLAN |
| L1.69     | TENNIS DIMENSION PLAN |
| L1.70     | TENNIS DIMENSION PLAN |
| L1.71     | TENNIS DIMENSION PLAN |
| L1.72     | TENNIS DIMENSION PLAN |
| L1.73     | TENNIS DIMENSION PLAN |
| L1.74     | TENNIS DIMENSION PLAN |
| L1.75     | TENNIS DIMENSION PLAN |
| L1.76     | TENNIS DIMENSION PLAN |
| L1.77     | TENNIS DIMENSION PLAN |
| L1.78     | TENNIS DIMENSION PLAN |
| L1.79     | TENNIS DIMENSION PLAN |
| L1.80     | TENNIS DIMENSION PLAN |
| L1.81     | TENNIS DIMENSION PLAN |
| L1.82     | TENNIS DIMENSION PLAN |
| L1.83     | TENNIS DIMENSION PLAN |
| L1.84     | TENNIS DIMENSION PLAN |
| L1.85     | TENNIS DIMENSION PLAN |
| L1.86     | TENNIS DIMENSION PLAN |
| L1.87     | TENNIS DIMENSION PLAN |
| L1.88     | TENNIS DIMENSION PLAN |
| L1.89     | TENNIS DIMENSION PLAN |
| L1.90     | TENNIS DIMENSION PLAN |
| L1.91     | TENNIS DIMENSION PLAN |
| L1.92     | TENNIS DIMENSION PLAN |
| L1.93     | TENNIS DIMENSION PLAN |
| L1.94     | TENNIS DIMENSION PLAN |
| L1.95     | TENNIS DIMENSION PLAN |
| L1.96     | TENNIS DIMENSION PLAN |
| L1.97     | TENNIS DIMENSION PLAN |
| L1.98     | TENNIS DIMENSION PLAN |
| L1.99     | TENNIS DIMENSION PLAN |
| L1.100    | TENNIS DIMENSION PLAN |

|                     |   |
|---------------------|---|
| STRUCTURAL          | STRUCTURAL NOTES  |
| S0.1                | TYPICAL DETAILS   |
| S0.2                | UNIT 100 TOILET/STORAGE FOUNDATION & ROOF FRAMING PLAN  |
| S1.0                | UNIT 100 TOILET/STORAGE ELEVATIONS, SECTIONS, & DETAILS |
| S2.0                | ENTRY ARCH ELEVATION & DETAILS                          |
| ARCHITECTURAL       | FIRST FLOOR COMPOSITE / CODE PLAN                       |
| A0.1                | ROOF COMPOSITE PLAN                                     |
| A0.2                | ATHLETICS ENTRY ARCH                                    |
| A0.3                | FIRST FLOOR PLAN - UNIT 100 TOILET / STORAGE            |
| A1.1                | FIRST FLOOR ENLARGED PLANS & DETAILS                    |
| A1.41               | FIRST FLOOR REFLECTED CEILINGS PLAN - UNIT 100          |
| A2.1                | EXTERIOR ELEVATIONS                                     |
| A3.1                | BUILDING SECTIONS                                       |
| A4.1                | WALL SECTIONS   |
| A6.1                | DOOR SCHEDULE, ELEVATIONS, & DETAILS                    |
| MECHANICAL/PLUMBING | MECHANICAL GENERAL INFORMATION                          |
| M0.0                | UNIT 100 TOILET/STORAGE PLUMBING PLANS                  |
| P0.0                | PLUMBING DETAILS & SCHEDULES                            |
| MECHANICAL          | UNIT 100 TOILET/STORAGE MECHANICAL PLANS                |
| M1.0                | MECHANICAL DETAILS, SCHEDULES, & CONTROLS               |
| ELECTRICAL          | ELECTRICAL GENERAL INFORMATION                          |
| E0.0                | LIGHTING SCHEDULES                                      |
| ELECTRICAL DEMO     | COMPOSITE ELECTRICAL SITE DEMO PLAN                     |
| E501.0              | ELECTRICAL SITE DEMO PLAN EAST                          |
| E501.1E             | ELECTRICAL SITE DEMO PLAN WEST                          |
| ELECTRICAL SITE     | COMPOSITE ELECTRICAL SITE PLAN                          |
| E51.0               | ELECTRICAL SITE PLAN EAST                               |
| E51.1E              | ELECTRICAL SITE PLAN WEST                               |
| ELECTRICAL          | UNIT 100 - TOILET/STORAGE ELECTRICAL PLANS              |
| E11                 | ELECTRICAL DETAILS                                      |
| E5.0                | PANEL SCHEDULES   |
| E7.0                | ELECTRICAL RISER DIAGRAM - DEMO                         |
| E11                 | ELECTRICAL RISER DIAGRAM - NEW WORK                     |

| ISSUANCES              | DATE       |
|------------------------|------------|
| CONSTRUCTION DOCUMENTS | 10/24/2024 |
| ADDENDUM 02            | 11/27/2024 |

JOB NO. 2900.09B

SHEET TITLE  
TITLE SHEET

SHEET NO.

**GO.1**





KALAMAZOO | CHELSEA | GRAND RAPIDS | ROYAL OAK

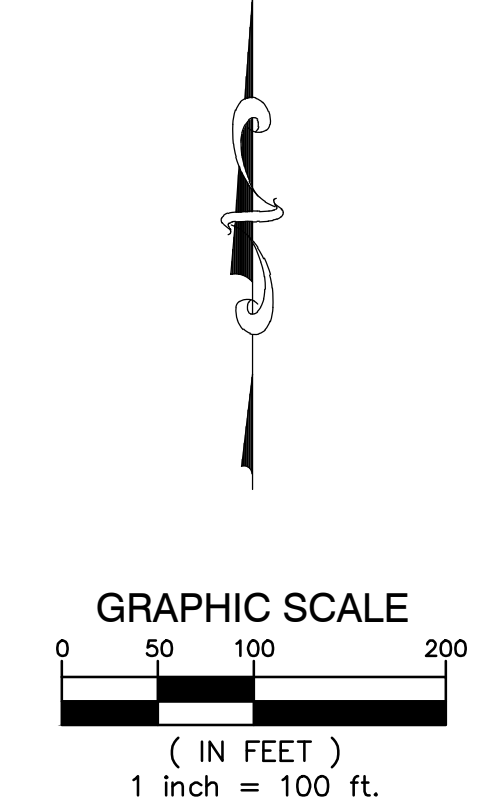
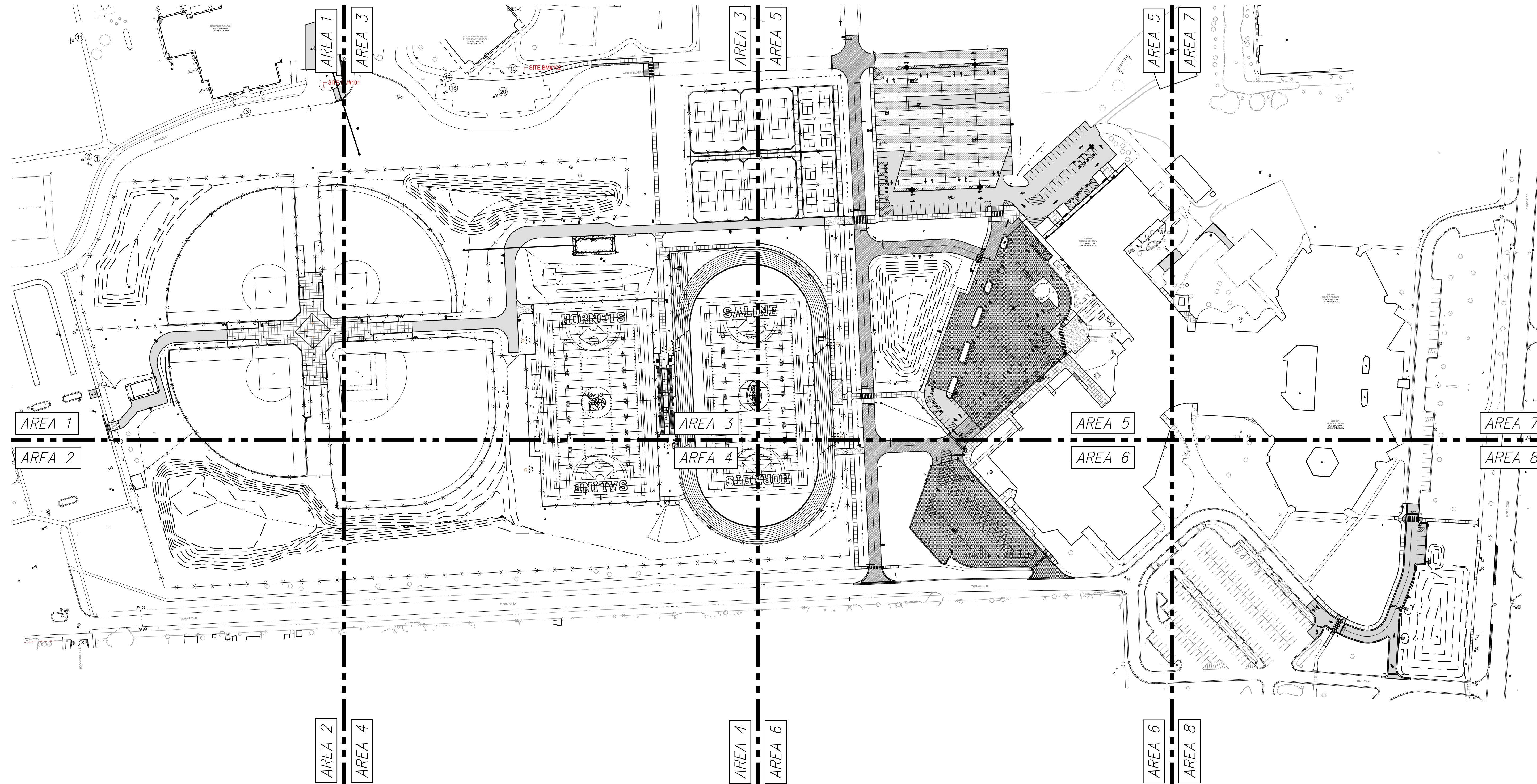

# MS REC COMPLEX

SALINE AREA SCHOOLS

7190 N. Maple Rd. Saline, MI 48176



| REVISIONS/REVIEW       | DATE       |
|------------------------|------------|
| SCHEMATIC DESIGN       | 05/02/2024 |
| DESIGN DEVELOPMENT     | 08/22/2024 |
| CONSTRUCTION DOCUMENTS | 10/24/2024 |
| ADDENDUM #1            | 11/20/2024 |
| ADDENDUM #2            | 11/26/2024 |

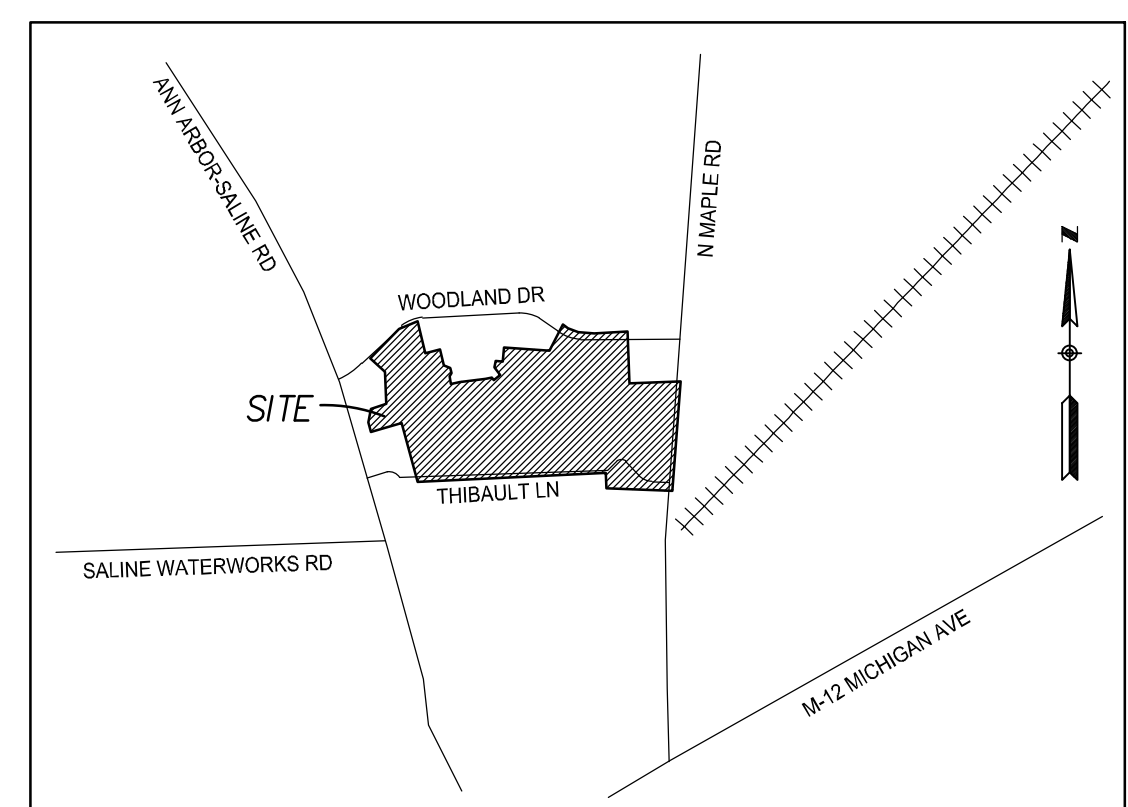

LOCATION MAP  
NOT TO SCALE

**OWNER**  
Saline Area Schools  
7265 North Ann Arbor St  
Saline, MI 48176  
Phone: (734) 401-4003

| CIVIL SHEET INDEX                        |   |   |
|--|---|---|
| C1.0 - GENERAL PLAN                      | C3.18 - STORMWATER PROFILES (1 OF 4)                  | C8.5 - TOPOGRAPHICAL SURVEY - (5 OF 15)                   |
| C1.1 - PHASING PLAN - (1 OF 2)           | C3.19 - STORMWATER PROFILES (2 OF 4)                  | C8.6 - TOPOGRAPHICAL SURVEY - (6 OF 15)                   |
| C1.2 - PHASING PLAN - (2 OF 2)           | C3.20 - STORMWATER PROFILES (3 OF 4)                  | C8.7 - TOPOGRAPHICAL SURVEY - (7 OF 15)                   |
| C2.0 - GENERAL DEMOLITION PLAN           | C3.21 - STORMWATER PROFILES (4 OF 4)                  | C8.8 - TOPOGRAPHICAL SURVEY - (8 OF 15)                   |
| C2.1 - DEMOLITION PLAN - (AREA 1)        | C4.0 - GENERAL PAVING PLAN                            | C8.9 - TOPOGRAPHICAL SURVEY - (9 OF 15)                   |
| C2.2 - DEMOLITION PLAN - (AREA 2)        | C4.1 - PAVING PLAN - (AREA 1)                         | C8.10 - TOPOGRAPHICAL SURVEY - (10 OF 15)                 |
| C2.3 - DEMOLITION PLAN - (AREA 3)        | C4.2 - PAVING PLAN - (AREA 2)                         | C8.11 - TOPOGRAPHICAL SURVEY - (11 OF 15)                 |
| C2.4 - DEMOLITION PLAN - (AREA 4)        | C4.3 - PAVING PLAN - (AREA 3)                         | C8.12 - TOPOGRAPHICAL SURVEY - (12 OF 15)                 |
| C2.5 - DEMOLITION PLAN - (AREA 5)        | C4.4 - PAVING PLAN - (AREA 4)                         | C8.13 - TOPOGRAPHICAL SURVEY - (13 OF 15)                 |
| C2.6 - DEMOLITION PLAN - (AREA 6)        | C4.5 - PAVING PLAN - (AREA 5)                         | C8.14 - TOPOGRAPHICAL SURVEY - (14 OF 15)                 |
| C2.7 - DEMOLITION PLAN - (AREA 7)        | C4.6 - PAVING PLAN - (AREA 6)                         | C8.15 - TOPOGRAPHICAL SURVEY - (15 OF 15)                 |
| C2.8 - DEMOLITION PLAN - (AREA 8)        | C4.7 - PAVING PLAN - (AREA 7)                         | C8.1 - CITY OF SALINE WATER MAIN STANDARD DETAILS W-1     |
| C3.0 - GENERAL UTILITY PLAN              | C4.8 - PAVING PLAN - (AREA 8)                         | C8.2 - CITY OF SALINE WATER MAIN STANDARD DETAILS W-2     |
| C3.1 - UTILITY PLAN - (AREA 1)           | C5.1 - PAVING DETAILS - (1 OF 2)                      | C8.3 - CITY OF SALINE WATER MAIN STANDARD DETAILS W-3     |
| C3.2 - UTILITY PLAN - (AREA 2)           | C5.2 - PAVING DETAILS - (2 OF 2)                      | C8.4 - CITY OF SALINE SANITARY SEWER STANDARD DETAILS S-1 |
| C3.3 - UTILITY PLAN - (AREA 3)           | C6.0 - GENERAL GRADING PLAN                           | C8.5 - CITY OF SALINE STORM SEWER STANDARD DETAILS ST-1   |
| C3.4 - UTILITY PLAN - (AREA 4)           | C6.1 - GRADING PLAN - (AREA 1)                        | C8.6 - CITY OF SALINE PAVEMENT STANDARD DETAILS P-1       |
| C3.5 - UTILITY PLAN - (AREA 5)           | C6.2 - GRADING PLAN - (AREA 2)                        |   |
| C3.6 - UTILITY PLAN - (AREA 6)           | C6.3 - GRADING PLAN - (AREA 3)                        |   |
| C3.7 - UTILITY PLAN - (AREA 7)           | C6.4 - GRADING PLAN - (AREA 4)                        |   |
| C3.8 - UTILITY PLAN - (AREA 8)           | C6.5 - GRADING PLAN - (AREA 5)                        |   |
| C3.9 - UTILITY DETAILS                   | C6.6 - GRADING PLAN - (AREA 6)                        |   |
| C3.10 - DETENTION DETAILS & CALCULATIONS | C6.7 - GRADING PLAN - (AREA 7)                        |   |
| C3.11 - OPERATIONS & MAINTENANCE PLAN    | C6.8 - GRADING PLAN - (AREA 8)                        |   |
| C3.12 - DRAINAGE AREA MAP - WEST         | C7.1 - SOIL EROSION AND SEDIMENTATION CONTROL PLAN    |   |
| C3.13 - DRAINAGE AREA MAP - EAST         | C7.2 - SOIL EROSION AND SEDIMENTATION CONTROL DETAILS |   |
| C3.14 - STORMWATER CALCULATIONS          | C8.1 - TOPOGRAPHICAL SURVEY - (1 OF 15)               |   |
| C3.15 - WATERMAIN PROFILES (1 OF 2)      | C8.2 - TOPOGRAPHICAL SURVEY - (2 OF 15)               |   |
| C3.16 - WATERMAIN PROFILES (2 OF 2)      | C8.3 - TOPOGRAPHICAL SURVEY - (3 OF 15)               |   |
| C3.17 - SANITARY PROFILE                 | C8.4 - TOPOGRAPHICAL SURVEY - (4 OF 15)               |   |

**LANDSCAPE SHEET INDEX**  
LA1.0 - LANDSCAPE PLAN  
LA2.0 - WAYFINDING PLAN

JOB NO. **2500-09A**  
SHEET TITLE  
General Plan

SHEET NO.  
**C1.0**  
© KINGS COTT ASSOCIATES INC. KALAMAZOO, MICHIGAN





**UNIT 100 - TOILET/STORAGE ROOF PLUMBING/MECHANICAL PLAN**  
SCALE: 1/4" = 1'-0"

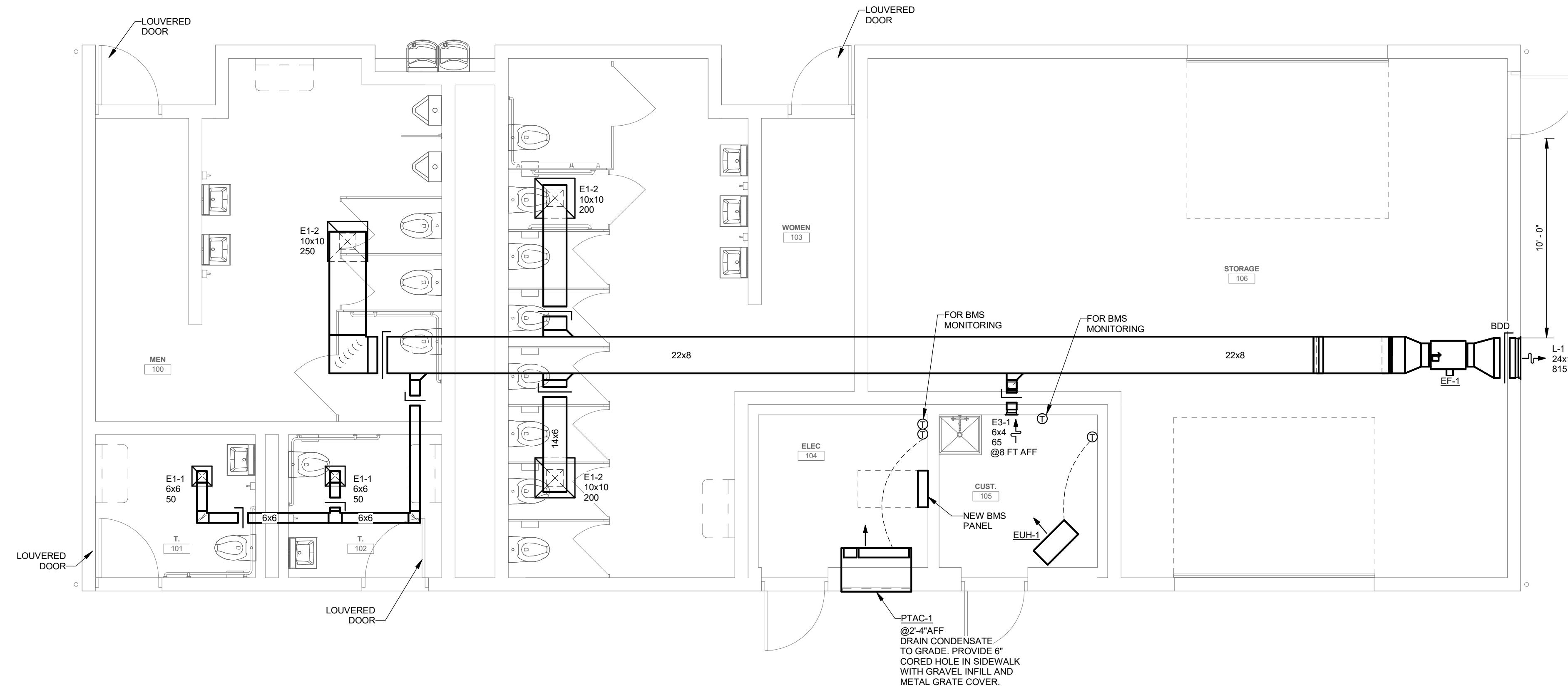

**UNIT 100 - TOILET/STORAGE MECHANICAL PLAN**  
SCALE: 1/4" = 1'-0"

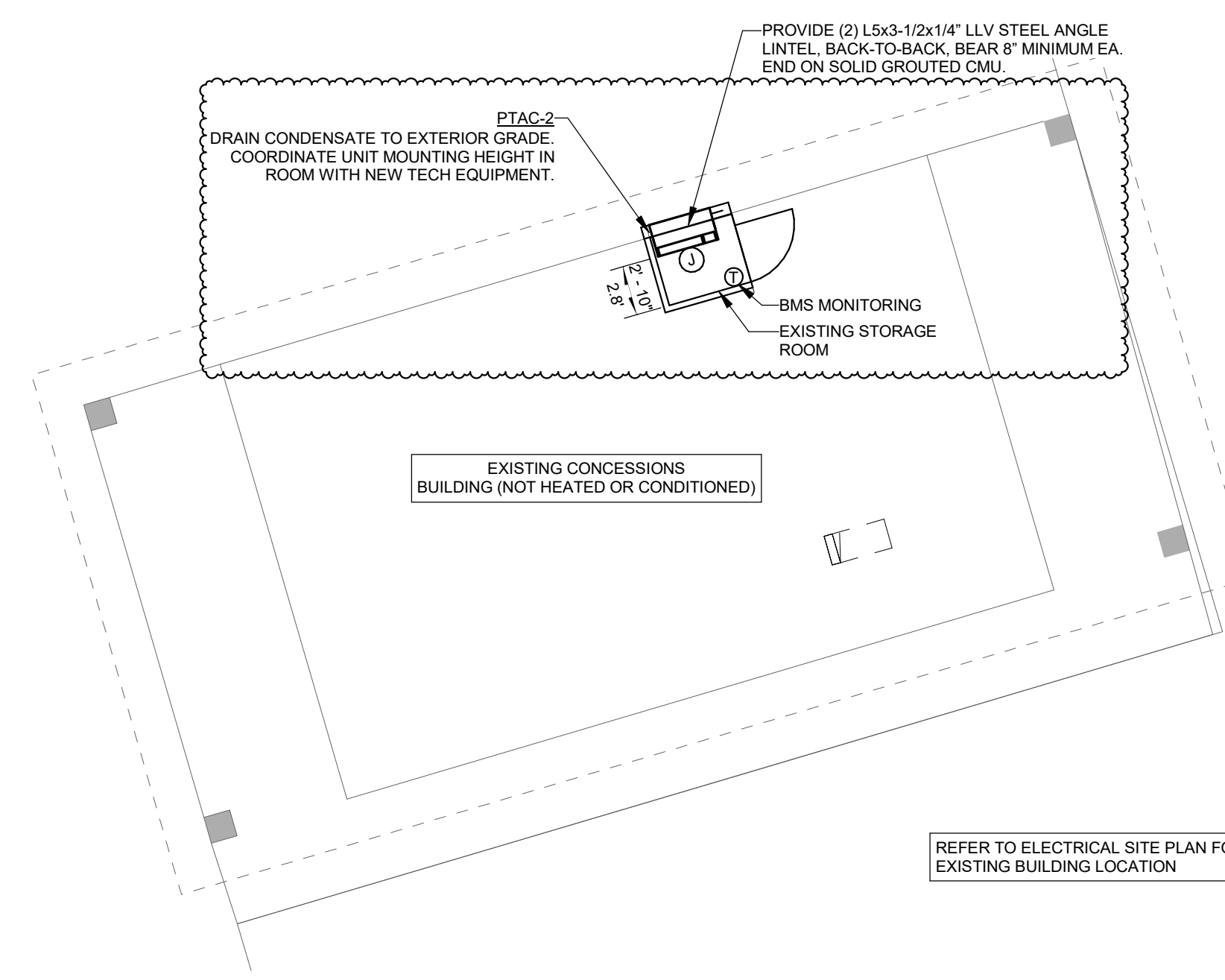

**EXISTING CONCESSIONS - MECHANICAL PLAN**  
SCALE: 1/8" = 1'-0"

**HVAC GENERAL NOTES**

1. THESE DRAWINGS ARE DIAGRAMMATIC AND INDICATE THE GENERAL EXTENT OF THE WORK. PROVIDE HVAC SYSTEMS COMPLETE PER SPECIFICATION, SMACNA STANDARDS, AND PER APPLICABLE CODES INCLUDING ALL NECESSARY OFFSETS, FITTINGS, SPECIAL RADII OR MITERED ELBOWS WHICH ARE REQUIRED DUE TO SPACE CONSTRAINTS OR STRUCTURAL CONDITIONS OR OTHER CONDITIONS.
2. CONTRACTOR SHALL COORDINATE THEIR WORK WITH THE WORK OF ALL OTHER TRADES. ALL DUCTWORK IS TO BE ROUTED AS HIGH AS POSSIBLE. PROVIDE ACCESS AROUND ALL NEW EQUIPMENT PER MANUFACTURER'S RECOMMENDATIONS. VERIFY ALL CLEARANCES PRIOR TO THE FABRICATION OF ANY WORK.
3. DUCTWORK SHALL NOT BE LOCATED OVER ELECTRICAL EQUIPMENT PANELS. PROVIDE REQUIRED CLEARANCE IN FRONT OF ELECTRICAL EQUIPMENT.
4. DUCTWORK SHALL NOT INTERFERE WITH ELECTRICAL EQUIPMENT CLEARANCE. DUCTWORK SHALL NOT BE INSTALLED IN A LOCATION THAT RESTRICTS THE ACCESS TO MECHANICAL DEVICES REQUIRING ACCESS.
5. THE CONTRACTOR SHALL PROVIDE ALL MISCELLANEOUS SUPPORTING STEEL, ETC. FOR THE PROPER INSTALLATION OF ALL MECHANICAL SYSTEMS.
6. COORDINATE FLOOR, WALL, ROOF PENETRATIONS, LOUVER SIZES, PAD LOCATIONS ETC. WITH ARCHITECTURAL TRADES. SEAL ALL PIPING AND DUCT PENETRATIONS.
7. THE CONTRACTOR SHALL REFER TO ARCHITECTURAL REFLECTED CEILING PLANS FOR EXACT LOCATION OF GRILLES, REGISTERS, AND DIFFUSERS.
8. COORDINATE AND PROVIDE ACCESS DOORS IN HARD CEILING AREAS FOR ACCESS TO BALANCING DAMPERS, ETC. REFER TO ARCHITECTURAL DRAWINGS FOR CEILING TYPES.
9. BRANCH DUCTWORK TO GRILLES, REGISTERS AND DIFFUSERS SHALL BE THE SAME SIZE AS THE GRILLE, REGISTER OR DIFFUSER NECK SIZE WHERE NO DUCT SIZE IS INDICATED ON PLAN.
10. PAINT ALL VISIBLE INTERIOR SURFACES OF EXHAUST/RETURN GRILLES, REGISTERS AND VISIBLE ASSOCIATED DUCTWORK FLAT BLACK.
11. PROVIDE CODE REQUIRED CLEARANCES/ACCESS DOORS FOR DAMPERS, VALVES, AND CLEANOUTS LOCATED IN WALLS OR ABOVE HARD CEILINGS. COORDINATE LOCATIONS WITH ARCHITECT. REFER TO ARCHITECTURAL PLANS FOR CEILING TYPES.
12. CONNECTION TO EQUIPMENT SHALL BE VERIFIED WITH MANUFACTURER'S CERTIFIED DRAWINGS. TRANSITIONS TO ALL EQUIPMENT SHALL BE VERIFIED AND PROVIDED FOR EQUIPMENT FURNISHED.
13. EXHAUST DUCTWORK CAN BE ROUTE BETWEEN TRUSS WEBBING, COORDINATE WITH FINAL TRUSS DIMENSIONS.



KALAMAZOO | CHELSEA | GRAND HARTS | ROYAL OAK

**MS REC COMPLEX**  
SALINE AREA SCHOOLS  
7190 N. Maple Rd. Saline, MI 48176

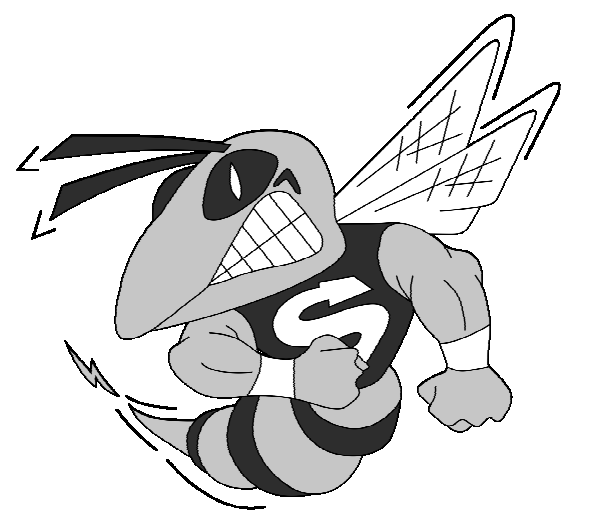

| ISSUANCES              | DATE       |
|------------------------|------------|
| DESIGN DEVELOPMENT     | 08/22/2024 |
| CONSTRUCTION DOCUMENTS | 10/24/2024 |
| ADDENDUM 02            | 11/27/2024 |

JOB NO. 2900.09B

SHEET TITLE  
UNIT 100 - TOILET/STORAGE  
MECHANICAL PLANS

SHEET NO.

**M1.1**



**Strategic Energy Solutions®**  
4000 W. Eleven Mile Road, Berkley, MI 48072  
Phone 248.399.1900 Fax 248.399.1901  
www.sesnet.com  
© 2024 SES, INC.  
SES Project # 23 0588 02

© KINGS-COTT ASSOCIATES INC. KALAMAZOO, MICHIGAN

THESE DRAWINGS AND THE WORK REPRESENTED THEREIN ARE THE PROPERTY OF SES AND SHALL NOT BE REPRODUCED OR TRANSMITTED IN ANY FORM OR BY ANY MEANS, ELECTRONIC OR MECHANICAL, WITHOUT PERMISSION.  
 C:\Users\sesnet\Documents\2023\2900.09B\02\_SAL MS REC Complex\_MEP\_2023\_11-27-2024.dwg



Saline Area Schools 2022 Bond Program (23-2914)

7265 Ann Arbor Street  
Saline, MI 48176

0191 - BP-3 : SMS Rec Complex - Allowance Clarification

**Subject**

BP-3 : SMS Rec Complex - Allowance Clarification

**Status**

Closed by Clark ●

**Discipline**

Civil

**Phase**

Preconstruction

**Location**

Bid Pack #3 – Saline MS Rec  
Complex

**Created On**

11/18/2024

**Due Date**

11/25/2024

**Date Resolved**

11/27/2024

**Author**

Matt Wielechowski  
Clark Construction Company

**Resolved By**

Matt Wielechowski  
Clark Construction Company

**QUESTION** Matt Wielechowski on 11/18/2024 03:41 PM

Section 012100, Allowance 1, has 1,000 CY of unsatisfactory soil excavation and disposal off-site and replacement with satisfactory soil material from off site. The allowance section then refers to Section 012200 to define the unit price to Add or Deduct against the allowance which notes “soil excavation and disposal off-site and replacement with satisfactory fill material or engineered fill from off-site.” Should the Bid Form unit price C.1. “Excavation of unsuitable soils and disposal off-site” include backfill? Or is one of the other requested unit prices on the bid form to correspond with the haul off.

- a. Please clarify how the allowance should be included in the bid. Are there additional allowances that need to be included in varying bid categories?
- b. Section 012200 3.1 only provides the description for one unit price. Please provide a detailed description and method of measurement for all requested unit prices on the bid form.

**ANSWER** Matt Wielechowski on 11/27/2024 10:24 AM (Promoted by Matt Wielechowski on 11/27/2024 11:06 AM)

- a. Include allowance as described in the bid category specific notes. Do not carry the allowance listed in Specification Section 012100, as it is duplicated in the bid category specific notes.
- b. Include unit prices listed in the bid form and on Building Connected. Kingscott Specification 012100 and 012200 are for reference and are superseded by CCC Front End Specification Sections, Including 012100 and 004126.

**ASSIGNMENTS**

Matt Wielechowski (Clark Construction Company) **Due On 11/25/2024**



0195 - BP-3 : SMS Rec Complex - Permits and Fees Clarification

**Subject**

BP-3 : SMS Rec Complex - Permits and Fees Clarification

**Status**

Closed by Clark ●

**Discipline**

All Disciplines

**Phase**

Preconstruction

**Location**

Bid Pack #3 – Saline MS Rec  
Complex

**Created On**

11/18/2024

**Due Date**

11/25/2024

**Date Resolved**

11/27/2024

**Author**

Matt Wielechowski  
Clark Construction Company

**Resolved By**

Matt Wielechowski  
Clark Construction Company

**QUESTION** Matt Wielechowski on 11/18/2024 03:46 PM

Section 002413-2.6 Notes all trade Contractors to pay for all permits and fees associated with their Work. Please specify what permits the site contractor will be required to obtain. Can allowance be made for the anticipated permits?

**ANSWER** Matt Wielechowski on 11/27/2024 11:10 AM

Bid Category 31A is responsible for work associated with bid category notes and related design specifications. Allowance of \$50,000 is included in Addendum 002 and updated in the Bid Category specific notes for 31A - Sitework.

**ASSIGNMENTS**

Matt Wielechowski (Clark Construction Company) **Due On 11/25/2024**

0219 - BP-3 : SMS Rec Complex - UST Removal Specification Scope Questions

**Subject**

BP-3 : SMS Rec Complex - UST Removal Specification Scope Questions

**Status**

Closed by Clark ●

**Discipline**

All Disciplines

**Phase**

Preconstruction

**Location**

**Created On**

11/20/2024

**Due Date**

11/27/2024

**Date Resolved**

11/27/2024

**Author**

Matt Wielechowski  
Clark Construction Company

**Resolved By**

Matt Wielechowski  
Clark Construction Company

**QUESTION** Matt Wielechowski on 11/20/2024 02:09 PM

Can you please provide a response to the following questions regarding Section 026500 UST System Removal:

1. 2.1.C indicates that the UST removal contractor is required to submit LARA/BFS tank forms.
  - a. Is this accurate or will the owner's environmental consultant, ARCH be handling regulatory submittals?
  
2. 2.1.P indicates it is the contractor's responsibility to arrange for proper waste characterization sampling with lab analysis prior to removal of waste from the site.
  - a. Will sampling be the responsibility of the UST removal contractor or will the owner's environmental consultant, ARCH be handling waste characterization sampling?
  - b. Are there any existing laboratory results from the area of the UST system from previous site investigations and are those available to provide the UST removal contractor?
  
3. 2.1.P indicates that the base bid should assume a total of 500 cubic yards of contaminated soils will be generated and will require disposal.
  - a. Should the base bid assume the contaminated soils are considered Non-Hazardous or Hazardous Waste?
  
4. 2.1.R indicates that dewatering and disposal is the responsibility of the UST removal contractor and that all water must be considered petroleum impacted.
  - a. What volume of liquids should be considered for the base bid?
  
5. 2.1.S and T indicates that all liquids associated with those remaining in the USTs and those resulting from cleaning the UST systems will require disposal.
  - a. What volume of liquids should be considered for the base bid?
  
6. 2.1.V indicates that additional excavation of potentially contaminated soils at the direct of the owner's environmental consultant for the purposes of sampling to determine if contamination exists.
  - a. Will a separate allowance volume be established for additional soil excavation/disposal beyond those described in 2.1.P (i.e., 500 cyds)? If not, will a bid form with unit costs be provided?
  
7. 2.1.W Indicates that additional excavation may be required following receipt of lab results.
  - a. How long will it take to receive lab results following sample collection?
  - b. Will these activities be included in the base bid or as a separate allowance with set unit costs?
  - c. Will a unit cost form be provided?

0219 - BP-3 : SMS Rec Complex - UST Removal Specification Scope Questions

---

**ANSWER** Matt Wielechowski on 11/27/2024 10:59 AM

1. The contractor, as the responsible party for UST removal activities, will be submitting the 30-day (pre-)notification of removal to LARA via BFS 3824.
  
  - 2.a. The contractor is responsible for handling waste characterization sampling and waste profile completion/submittal to their selected disposal facility. Costs for specific analysis as specified by the disposal facility should be accounted for in the bid cost. AEG will provide support and guidance for these activities.
  - 2.b. AEG does not have existing laboratory results from the area of the UST
  
  3. AEG recommends assuming costs for Non-Hazardous contaminated soils in the base bid.
  
  4. Please assume a volume of 220 gallons (of petroleum impacted liquid waste) for disposal within the base bid.
  
  5. Please assume a volume for disposal from fuel removal (within 1" of the tank bottom) along with typical cleaning activities of a 2,000-gallon and 12,000-gallon UST.
  
  6. Bidders should provide for a 150 cubic yard allowance volume in the event additional soil excavation/disposal is needed beyond 500 cubic yards.
  
  - 7.a. AEG plans to submit samples for RUSH analysis once taken from the field. Please allow for 7-10 business days for receipt of the lab results.
  - 7.b. Additional excavation should be provided as a separate allowance with set unit costs.
  - 7.c. No
- 

**ASSIGNMENTS**

Trevor Garland (Kingscott Associates, Inc.) Done On 11/25/2024

0223 - BP-3 : SMS Rec Complex - MDP-2 Clarification

**Subject**

BP-3 : SMS Rec Complex - MDP-2 Clarification

**Status**

Closed by Clark ●

**Discipline**

Electrical

**Phase**

Preconstruction

**Location**

**Created On**

11/22/2024

**Due Date**

11/29/2024

**Date Resolved**

11/26/2024

**Author**

Matt Wielechowski  
Clark Construction Company

**Resolved By**

Matt Wielechowski  
Clark Construction Company

**QUESTION** Matt Wielechowski on 11/22/2024 10:34 AM

MDP-2 calls for a 400a breaker. There is no room for this. Please advise.

**ANSWER** Matt Wielechowski on 11/26/2024 01:00 PM

MDP-1 in the middle school not MDP-2. The middle school also has an MDP-2 but it is on the other side of the building in Zone L.

This is planned to be resolved with the concurrent work in the middle school / senior center renovation work. In MDP-1 there is a 400A breaker set at 350A that feeds an older 400A panel "DP-Z" which is in the boiler room near MDP-1. That panel feeds main circulation pumps and the boiler, and some AHU that are being revised in the MS renovation scope. It was the intention that this panel will be replaced and revised to 250A and can then be fed from MDP-1 with one of the spare 250A spaces with revisions to what this panel feeds. When that is complete there will be a 400A slot available in MDP-1 for the Rec complex work.

**ASSIGNMENTS**

Trevor Garland (Kingscott Associates, Inc.) Done On 11/25/2024

0224 - BP-3 : SMS Rec Complex - 42" Storm Pipe Crossing Baseball Field

**Subject**

**Status**

BP-3 : SMS Rec Complex - 42" Storm Pipe Crossing Baseball Field

Closed by Clark ●

**Discipline**

**Phase**

**Location**

Civil

Preconstruction

**Created On**

**Due Date**

**Date Resolved**

11/22/2024

11/29/2024

11/26/2024

**Author**

**Resolved By**

Matt Wielechowski  
Clark Construction Company

Matt Wielechowski  
Clark Construction Company

**QUESTION** Matt Wielechowski on 11/22/2024 10:43 AM

1. There is a deep 42" Storm pipe crossing the baseball, Field. The profile shows no sand backfill for the trench in that area. Since that area is critical and to avoid settlement, can you please clarify if the onsite material is suitable for backfill under the baseball area?
2. Permit and tap fees cost undetermined until final plan submitted to the city for final review. Can you please set allowance for permit and tap fees costs or exclude it from our scope?

**ANSWER** Matt Wielechowski on 11/26/2024 11:36 PM

1. On-site material for the baseball fields is acceptable. However, the backfill should be placed in compacted 8" lifts and observed and approved by the on-site material tester.
2. See revised Bid Category Scope of Work for 31A - Sitework published in Addendum 002. Including additional bid category allowances for permit and tap fees.

**ASSIGNMENTS**

Trevor Garland (Kingscott Associates, Inc.) Due On 11/29/2024

Matt Wielechowski (Clark Construction Company) Due On 11/29/2024

0226 - BP-3 : SMS Rec Complex - Grading and Fine Grading Scope Clarification - Multiple Bid Categories

**Subject**

BP-3 : SMS Rec Complex - Grading and Fine Grading Scope Clarification - Multiple Bid Categories

**Status**

Closed by Clark ●

**Discipline**

Civil

**Phase**

Preconstruction

**Location**

Bid Pack #3 – Saline MS Rec Complex

**Created On**

11/26/2024

**Due Date**

12/3/2024

**Date Resolved**

11/26/2024

**Author**

Matt Wielechowski  
Clark Construction Company

**Resolved By**

Matt Wielechowski  
Clark Construction Company

**QUESTION** Matt Wielechowski on 11/26/2024 08:34 AM

Bid Category Specific Note 12 for Bid Scope (03) notes to furnish, grade, and compact granulator base material. Bid Category Specific Note 7 for Bid Scope (32A) notes to furnish, place and grade stone base. In the pre bid meeting it was discussed there was a desire to have the site contractor (31A) include placement of the aggregate subbase for the asphalt and granular base for the concrete flat work with fine grade to be included in the concrete(03) and asphalt (32A) scopes of work. Will placement and initial compaction/grade be added to the (31A) scope of work with final fine grade to the respective paving sub- contractor?

**ANSWER** Matt Wielechowski on 11/26/2024 11:03 PM (Promoted by Matt Wielechowski on 11/27/2024 07:37 AM)

See attached scope breakdown and revised Bid Category Specific Notes for delineation of scope.

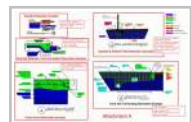

File

Attachment A - Si...  
Matt Wielechowski

**ASSIGNMENTS**

Matt Wielechowski (Clark Construction Company) Due On 12/3/2024

0227 - BP-3 : SMS Rec Complex - Athletic Field Allowable Fill per Spec 3120210

**Subject**

BP-3 : SMS Rec Complex - Athletic Field Allowable Fill per Spec 3120210

**Status**

Closed by Clark ●

**Discipline**

Civil

**Phase**

Preconstruction

**Location**

Bid Pack #3 – Saline MS Rec  
Complex

**Created On**

11/26/2024

**Due Date**

12/3/2024

**Date Resolved**

11/26/2024

**Author**

Matt Wielechowski  
Clark Construction Company

**Resolved By**

Matt Wielechowski  
Clark Construction Company

**QUESTION** Matt Wielechowski on 11/26/2024 08:36 AM

Section 3120210-3.6-C. lists 6 defined areas and the allowable fill material to be used. In what category do the athletic fields fall under.

**ANSWER** Matt Wielechowski on 11/26/2024 12:52 PM

It can be considered the same as 3.12.C.2: Use satisfactory soil material as long as the geotechnical engineer deems the material to be suitable and the compaction requirements are met or engineered fill.

**ASSIGNMENTS**

Trevor Garland (Kingscott Associates, Inc.) Due On 12/3/2024

0228 - BP-3 : SMS Rec Complex - Bid Category 31A Note 16 Clarification

**Subject**

BP-3 : SMS Rec Complex - Bid Category 31A Note 16 Clarification

**Status**

Closed by Clark ●

**Discipline**

Civil

**Phase**

Preconstruction

**Location**

Bid Pack #3 – Saline MS Rec  
Complex

**Created On**

11/26/2024

**Due Date**

12/3/2024

**Date Resolved**

11/26/2024

**Author**

Matt Wielechowski  
Clark Construction Company

**Resolved By**

Matt Wielechowski  
Clark Construction Company

**QUESTION** Matt Wielechowski on 11/26/2024 08:37 AM

Please provide additional clarification to the area and required work referenced in Bid Category Specific Note 16 for Bid Scope (31A).

**ANSWER** Matt Wielechowski on 11/26/2024 02:48 PM

See Addendum 002 for scope clarification.

**ASSIGNMENTS**

Matt Wielechowski (Clark Construction Company) Due On 12/3/2024



0229 - BP-3 : SMS Rec Complex - Post Tension Concrete Request

**Subject**

BP-3 : SMS Rec Complex - Post Tension Concrete Request

**Status**

Closed by Clark ●

**Discipline**

Civil

**Phase**

Preconstruction

**Location**

Bid Pack #3 – Saline MS Rec  
Complex

**Created On**

11/26/2024

**Due Date**

12/3/2024

**Date Resolved**

11/26/2024

**Author**

Matt Wielechowski  
Clark Construction Company

**Resolved By**

Matt Wielechowski  
Clark Construction Company

**QUESTION** Matt Wielechowski on 11/26/2024 08:38 AM

Please consider adding the post tensioned concrete to Bid Category 32D. Conversations with post tensioned concrete installers have mentioned that they need to control and coordinate the installation of the tennis net tension system and posts and would greatly improve the quality of the finished product.

**ANSWER** Matt Wielechowski on 11/26/2024 02:52 PM

Post tensioned concrete to remain in bid category 03 - Concrete. Close coordination required between Bid Category 32D and Bid Category 03.

**ASSIGNMENTS**

Matt Wielechowski (Clark Construction Company) Due On 12/3/2024

0230 - BP-3 : SMS Rec Complex - Fence Foundations and Poles

**Subject**

BP-3 : SMS Rec Complex - Fence Foundations and Poles

**Status**

Closed by Clark ●

**Discipline**

Civil

**Phase**

Preconstruction

**Location**

Bid Pack #3 – Saline MS Rec  
Complex

**Created On**

11/26/2024

**Due Date**

12/3/2024

**Date Resolved**

11/26/2024

**Author**

Matt Wielechowski  
Clark Construction Company

**Resolved By**

Matt Wielechowski  
Clark Construction Company

**QUESTION** Matt Wielechowski on 11/26/2024 08:39 AM

Will the fence foundations and poles be installed prior to the concrete band and sidewalks. Or will the fence posts be cored and grouted after the concrete is installed. Please clarify.

**ANSWER** Matt Wielechowski on 11/26/2024 03:08 PM

Fence foundations and poles will be installed prior to the concrete band and sidewalks.

**ASSIGNMENTS**

Matt Wielechowski (Clark Construction Company) Due On 12/3/2024

0231 - BP-3 : SMS Rec Complex - Soil Erosion Control Phasing

**Subject**

BP-3 : SMS Rec Complex - Soil Erosion Control Phasing

**Status**

Closed by Clark ●

**Discipline**

Civil

**Phase**

Preconstruction

**Location**

Bid Pack #3 – Saline MS Rec  
Complex

**Created On**

11/26/2024

**Due Date**

12/3/2024

**Date Resolved**

11/26/2024

**Author**

Matt Wielechowski  
Clark Construction Company

**Resolved By**

Matt Wielechowski  
Clark Construction Company

**QUESTION** Matt Wielechowski on 11/26/2024 08:40 AM

Please provide soil erosion plans by phase. Sheets 7.1 is an overall SESC plan only. With this project being multi year there will be the need for additional silt fence and inlet protection between PH1/2 (2025) and Phase 3 (2026). Also, please include existing structure will require inlet protection between phases and prior to demolition activities.

**ANSWER** Matt Wielechowski on 11/26/2024 12:50 PM

- Attached is some additional clarification for phasing
- Attached sheet also includes additional silt fence to be included for phase 2. We do not anticipate additional inlet protection at this time.
- All existing structures require inlet protection as shown on the SESC plan

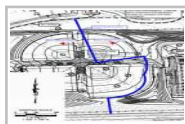

File

RFI 0231 SESC.pdf  
Matt Wielechowski

**ASSIGNMENTS**

Trevor Garland (Kingscott Associates, Inc.) Due On 12/3/2024

LOCATION APPROXIMATE. CONFIRM WITH CONSTRUCTION MANAGER DURING ALL PHASES FOR FINAL PLACEMENT.

SITE BM#101

SILT FENCE

silt fence required for phasing per plan

SESC measures in Phase 3

SESC measures in Phase 2

INLET PROTECTION - FABRIC DROP



GRAPHIC SCALE

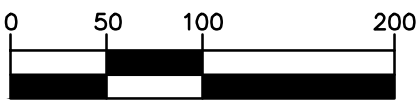

( IN FEET )  
1 inch = 100 ft.

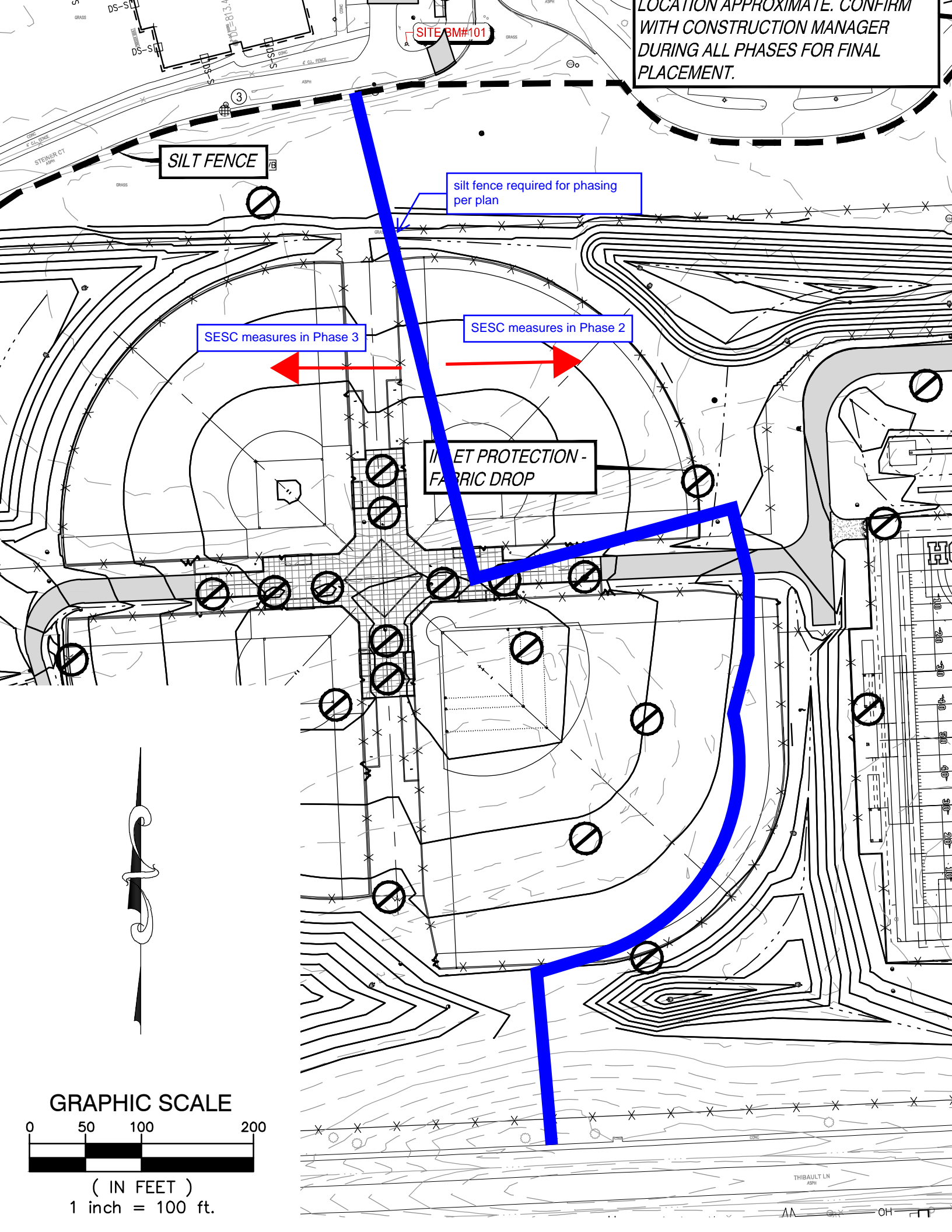

THIBAUT LN ASPH

AA OH

0232 - BP-3 : SMS Rec Complex - Long Jump Pit Sand and Shot Put Aggregate Scope

**Subject**

BP-3 : SMS Rec Complex - Long Jump Pit Sand and Shot Put Aggregate Scope

**Status**

Closed by Clark ●

**Discipline**

Civil

**Phase**

Preconstruction

**Location**

Bid Pack #3 – Saline MS Rec  
Complex

**Created On**

11/26/2024

**Due Date**

12/3/2024

**Date Resolved**

11/26/2024

**Author**

Matt Wielechowski  
Clark Construction Company

**Resolved By**

Matt Wielechowski  
Clark Construction Company

**QUESTION** Matt Wielechowski on 11/26/2024 08:42 AM

Please clarify what BC is to install the long jump pit sand and shot-put landing aggregate.

**ANSWER** Matt Wielechowski on 11/26/2024 03:04 PM

Bid Category 03 - Concrete is responsible for long jump pit sand and shot-put landing aggregate per Bid Category Specific Notes. See "Base Specifications" for included scope of work.

**ASSIGNMENTS**

Matt Wielechowski (Clark Construction Company) Due On 12/3/2024

0233 - BP-3 : SMS Rec Complex - Aluminum Benches Scope Responsibility

---

**Subject**

BP-3 : SMS Rec Complex - Aluminum Benches Scope Responsibility

**Status**

Closed by Clark ●

**Discipline**

Civil

**Phase**

Preconstruction

**Location**

Bid Pack #3 – Saline MS Rec  
Complex

**Created On**

11/26/2024

**Due Date**

12/3/2024

**Date Resolved**

11/26/2024

**Author**

Matt Wielechowski  
Clark Construction Company

**Resolved By**

Matt Wielechowski  
Clark Construction Company

**QUESTION** Matt Wielechowski on 11/26/2024 08:43 AM

Please clarify what BC is supplying aluminum benches.

.....  
**ANSWER** Matt Wielechowski on 11/26/2024 03:05 PM

Aluminum benches is to be provided and installed by bid category 03-Concrete per Bid Category Specific Notes.

.....  
**ASSIGNMENTS**

Matt Wielechowski (Clark Construction Company) Due On 12/3/2024

0234 - BP-3 : SMS Rec Complex - Foundation Backfill and Subbase at Restroom Building

**Subject**

BP-3 : SMS Rec Complex - Foundation Backfill and Subbase at Restroom Building

**Status**

Closed by Clark ●

**Discipline**

Civil

**Phase**

Preconstruction

**Location**

Bid Pack #3 – Saline MS Rec  
Complex

**Created On**

11/26/2024

**Due Date**

12/3/2024

**Date Resolved**

11/26/2024

**Author**

Matt Wielechowski  
Clark Construction Company

**Resolved By**

Matt Wielechowski  
Clark Construction Company

**QUESTION** Matt Wielechowski on 11/26/2024 08:44 AM

What BC is responsible for the foundation backfill and 4" sand subbase at the restrooms building.

**ANSWER** Matt Wielechowski on 11/26/2024 11:04 PM

Bid Category 03 - Concrete is responsible for the foundation backfill and the sand subbase at the restroom building.

**ASSIGNMENTS**

Matt Wielechowski (Clark Construction Company) Due On 12/3/2024

0235 - BP-3 : SMS Rec Complex - Remove and Salvage Chain Link Fence Scope Responsibility

**Subject**

BP-3 : SMS Rec Complex - Remove and Salvage Chain Link Fence Scope Responsibility

**Status**

Closed by Clark ●

**Discipline**

Civil

**Phase**

Preconstruction

**Location**

Bid Pack #3 – Saline MS Rec Complex

**Created On**

11/26/2024

**Due Date**

12/3/2024

**Date Resolved**

11/26/2024

**Author**

Matt Wielechowski  
Clark Construction Company

**Resolved By**

Matt Wielechowski  
Clark Construction Company

**QUESTION** Matt Wielechowski on 11/26/2024 08:45 AM

Note 8 on the demo sheets notes remove and salvage chain link fence, gates, posts, and footings to a specified location. Please confirm what bid category is responsible for the remove/salvage and resetting of the salvaged items for the fence.

**ANSWER** Matt Wielechowski on 11/26/2024 03:11 PM

Bid Category 32E - Fencing is responsible to remove and salvage chain link fence, gates, posts, and footings to a specified location. All fencing called to be removed and disposed of is by Bid Category 31A.

**ASSIGNMENTS**

Matt Wielechowski (Clark Construction Company) Due On 12/3/2024



0236 - BP-3 : SMS Rec Complex - Snow Fence Allowance

**Subject**

BP-3 : SMS Rec Complex - Snow Fence Allowance

**Status**

Closed by Clark ●

**Discipline**

Civil

**Phase**

Preconstruction

**Location**

Bid Pack #3 – Saline MS Rec  
Complex

**Created On**

11/26/2024

**Due Date**

12/3/2024

**Date Resolved**

11/26/2024

**Author**

Matt Wielechowski  
Clark Construction Company

**Resolved By**

Matt Wielechowski  
Clark Construction Company

**QUESTION** Matt Wielechowski on 11/26/2024 08:46 AM

Section 002416, Bid Category 31A, Sitework and Grading Note 19. Notes to include an allowance of \$10,000 dollars for snow fence. Will there be a unit price established for snow fence? Is this different than the tree protection fence as shown on the demo sheets and detail on C2.2?

**ANSWER** Matt Wielechowski on 11/26/2024 02:59 PM

The snow fence allowance is to be above and beyond what is required per the demolition drawings. Please reference Front End Specification Section 012100 for lump sum allowances requirements. No unit pricing will be established for snow fencing at this time.

**ASSIGNMENTS**

Matt Wielechowski (Clark Construction Company) Due On 12/3/2024

0237 - BP-3 : SMS Rec Complex - Civil Demo Drawing, Note 15 - Clarification

**Subject**

BP-3 : SMS Rec Complex - Civil Demo Drawing, Note 15 - Clarification

**Status**

Closed by Clark ●

**Discipline**

Civil

**Phase**

Preconstruction

**Location**

Bid Pack #3 – Saline MS Rec  
Complex

**Created On**

11/26/2024

**Due Date**

12/3/2024

**Date Resolved**

11/26/2024

**Author**

Matt Wielechowski  
Clark Construction Company

**Resolved By**

Matt Wielechowski  
Clark Construction Company

**QUESTION** Matt Wielechowski on 11/26/2024 08:48 AM

Note 15 on the demo sheets call out for the contractor to scope pipe before work to confirm connections prior to abandonment. Have the existing storm sewers been cleaned and television? If so, can it please be provided to the bidding contractors?

**ANSWER** Matt Wielechowski on 11/26/2024 01:01 PM

The sewers have not been cleaned or televised.

**ASSIGNMENTS**

Trevor Garland (Kingscott Associates, Inc.) Due On 12/3/2024

Matt Wielechowski (Clark Construction Company) Due On 12/3/2024

0238 - BP-3 : SMS Rec Complex - C2.1 Existing Hydrant Clarification

**Subject**

BP-3 : SMS Rec Complex - C2.1 Existing Hydrant Clarification

**Status**

Closed by Clark ●

**Discipline**

Civil

**Phase**

Preconstruction

**Location**

Bid Pack #3 – Saline MS Rec  
Complex

**Created On**

11/26/2024

**Due Date**

12/3/2024

**Date Resolved**

11/26/2024

**Author**

Matt Wielechowski  
Clark Construction Company

**Resolved By**

Matt Wielechowski  
Clark Construction Company

**QUESTION** Matt Wielechowski on 11/26/2024 08:49 AM

Sheet C2.1 calls out for the existing hydrant to be removed. What size of water main and type of material should the bidding contractors assume for this work? Is the existing hydrant to be removed a dead-end hydrant? Should the exploratory excavation for this work be an allowance and considered the same exploratory excavation noted for the new hydrant to be installed on sheet C3.2? If not, what should the bidding contractors assume for the exploratory excavation L/E/M in the base bid? Please confirm if the intent of the new hydrant shown on sheet C3.2 to be a dead-end hydrant?

**ANSWER** Matt Wielechowski on 11/26/2024 12:59 PM

Q. Sheet C2.1 calls out for the existing hydrant to be removed. What size of water main and type of material should the bidding contractors assume for this work?

A. Assume 6" ductile iron for removal

Q. Is the existing hydrant to be removed a dead-end hydrant?

A. Assume the existing hydrant is a dead-end

Q. Should the exploratory excavation for this work be an allowance and considered the same exploratory excavation noted for the new hydrant to be installed on sheet C3.2?

A. Include a \$10,000 allowance for exploratory excavation for this work. See revised Bid Category Notes for 31A to include this allowance.

Q. Please confirm if the intent of the new hydrant shown on sheet C3.2 to be a dead-end hydrant?

A. The intent is to be a dead-end hydrant assembly

**ASSIGNMENTS**

Trevor Garland (Kingscott Associates, Inc.) Due On 12/3/2024

0239 - BP-3 : SMS Rec Complex - C2.5 Allowance for Locating and Abandoning Water Service

**Subject**

**Status**

BP-3 : SMS Rec Complex - C2.5 Allowance for Locating and Abandoning Water Service

Closed by Clark ●

**Discipline**

**Phase**

**Location**

Civil

Preconstruction

Bid Pack #3 – Saline MS Rec  
Complex

**Created On**

**Due Date**

**Date Resolved**

11/26/2024

12/3/2024

11/26/2024

**Author**

**Resolved By**

Matt Wielechowski  
Clark Construction Company

Matt Wielechowski  
Clark Construction Company

**QUESTION** Matt Wielechowski on 11/26/2024 08:51 AM

Sheet C2.5 notes and allowance for locating and abandoning water service. Will an allowance be added. What should the bidding contractors assume for the allowance and the existing water service? Based on the provided information this work will need to take place outside of the designated work area.

**ANSWER** Matt Wielechowski on 11/26/2024 01:00 PM

The contractor shall assume 120 LF of 6" water main to be abandoned in place

**ASSIGNMENTS**

Matt Wielechowski (Clark Construction Company) Due On 12/3/2024

Trevor Garland (Kingscott Associates, Inc.) Due On 12/3/2024

0240 - BP-3 : SMS Rec Complex - 6" Water Service Clarification

**Subject**

BP-3 : SMS Rec Complex - 6" Water Service Clarification

**Status**

Closed by Clark ●

**Discipline**

Civil

**Phase**

Preconstruction

**Location**

Bid Pack #3 – Saline MS Rec  
Complex

**Created On**

11/26/2024

**Due Date**

12/3/2024

**Date Resolved**

11/26/2024

**Author**

Matt Wielechowski  
Clark Construction Company

**Resolved By**

Matt Wielechowski  
Clark Construction Company

**QUESTION** Matt Wielechowski on 11/26/2024 08:52 AM

Is there an existing water service at the proposed site 6" domestic water service for the middle school or is this a new service location to abandon the old service noted on sheet C2.5.

**ANSWER** Matt Wielechowski on 11/26/2024 12:53 PM

The service from Maple to the hydrant is to remain. The service from the hydrant to the building is to be abandoned. The new service north of the school will be the building service.

**ASSIGNMENTS**

Trevor Garland (Kingscott Associates, Inc.) Due On 12/3/2024

0241 - BP-3 : SMS Rec Complex - Water Service Testing Scope Responsibility

---

**Subject**

BP-3 : SMS Rec Complex - Water Service Testing Scope Responsibility

**Status**

Closed by Clark ●

**Discipline**

Civil

**Phase**

Preconstruction

**Location**

Bid Pack #3 – Saline MS Rec  
Complex

**Created On**

11/26/2024

**Due Date**

12/3/2024

**Date Resolved**

11/26/2024

**Author**

Matt Wielechowski  
Clark Construction Company

**Resolved By**

Matt Wielechowski  
Clark Construction Company

**QUESTION** Matt Wielechowski on 11/26/2024 08:54 AM

Please confirm the site contractor will not be responsible for any water service risers and will only be responsible for pressure and bacteria testing 5'outside of the buildings.

**ANSWER** Matt Wielechowski on 11/26/2024 01:04 PM

Correct. All work inside the building related to the Water Main is to be completed outside of this scope of work.

**ASSIGNMENTS**

Matt Wielechowski (Clark Construction Company) Due On 12/3/2024

0242 - BP-3 : SMS Rec Complex - Locate Private UG Utilities Scope Responsibility

**Subject**

BP-3 : SMS Rec Complex - Locate Private UG Utilities Scope Responsibility

**Status**

Closed by Clark ●

**Discipline**

Civil

**Phase**

Preconstruction

**Location**

Bid Pack #3 – Saline MS Rec  
Complex

**Created On**

11/26/2024

**Due Date**

12/3/2024

**Date Resolved**

11/26/2024

**Author**

Matt Wielechowski  
Clark Construction Company

**Resolved By**

Matt Wielechowski  
Clark Construction Company

**QUESTION** Matt Wielechowski on 11/26/2024 08:55 AM

Section 2416 bid scopes 02, 03, 31A all contain the same note to “Determine location of existing underground utilities prior to any excavation work outside of the responsibility of MISS DIG for marking including fiber optic lines and other non-public utilities.” What assumptions and required due diligence required of the bidding contractors to fulfill this requirement. Can an allowance be added to different scopes of work to ensure an equal bid? Or can the school/engineer hire a locating company to determine the location of the existing facilities, survey the location and provide a map to all trades of the existing facilities?

**ANSWER** Matt Wielechowski on 11/26/2024 11:06 PM

See revised Bid Category Scope of Work published in Addendum 002. Remove requirement from other bid categories to locate private utilities. Add an allowance of \$10,000 for locating private utilities in Bid Category 31A - Sitework.

**ASSIGNMENTS**

Matt Wielechowski (Clark Construction Company) Due On 12/3/2024

0243 - BP-3 : SMS Rec Complex - Bid Affidavit Requirements for Building Connected

**Subject**

BP-3 : SMS Rec Complex - Bid Affidavit Requirements for Building Connected

**Status**

Closed by Clark ●

**Discipline**

Civil

**Phase**

Preconstruction

**Location**

Bid Pack #3 – Saline MS Rec  
Complex

**Created On**

11/26/2024

**Due Date**

12/3/2024

**Date Resolved**

11/26/2024

**Author**

Matt Wielechowski  
Clark Construction Company

**Resolved By**

Matt Wielechowski  
Clark Construction Company

**QUESTION** Matt Wielechowski on 11/26/2024 08:57 AM

Please confirm how the required Bid Security, Iran Economic Sanctions Act - Notarized Statement, Familial Disclosure - Notarized Statement, and Criminal Background Check affidavit are to be submitted on Building Connected?

**ANSWER** Matt Wielechowski on 11/26/2024 01:23 PM

Bid Bond, Familial, Iran Sanction and Criminal Background Affidavits must be uploaded to the file section on Building Connected. The following instruction will be added to Specification Section 002113 - Instruction to Bidders, including item 4, 5 and 6. "If the bid is submitted electronically, the original document shall be delivered to the District prior to a recommendation for award to the Board of Education".

**ASSIGNMENTS**

Matt Wielechowski (Clark Construction Company) Due On 12/3/2024



0244 - BP-3 : SMS Rec Complex - Excavated Material Fill Requirement Clarification

**Subject**

BP-3 : SMS Rec Complex - Excavated Material Fill Requirement Clarification

**Status**

Closed by Clark ●

**Discipline**

Civil

**Phase**

Preconstruction

**Location**

Bid Pack #3 – Saline MS Rec  
Complex

**Created On**

11/26/2024

**Due Date**

12/3/2024

**Date Resolved**

11/27/2024

**Author**

Matt Wielechowski  
Clark Construction Company

**Resolved By**

Matt Wielechowski  
Clark Construction Company

**QUESTION** Matt Wielechowski on 11/26/2024 08:58 AM

Please confirm the site contractor can assume all excavated material can be used as fill under green spaces, pavements, and if the owner’s geotechnical representative deems the material not satisfactory to be used for embankment under the aforementioned areas the contractor will be compensated to haul off and import as directed if determined unsuitable. RFI question/answer 0202- BP-3: SMS Rec Complex – Section 312000-3 – Suitable Soil for Backfill, addresses the anticipated CL and ML material can be used on site under greenspaces but the actual quantity of suitable vs. unsuitable excavated material is unknown. If we cannot make the above assumption, please clarify what should be assumed for quantity of satisfactory soil materials vs. unsatisfactory soil materials

**ANSWER** Matt Wielechowski on 11/27/2024 10:42 AM

On-site material is assumed to be suitable (per the contract documents). If material testing engineer finds excavated material to be unsuitable (per the contract documents), then the allowances will be utilized from the Bid Package Specific Notes. See Addendum 002 for updated allowances.

**ASSIGNMENTS**

Trevor Garland (Kingscott Associates, Inc.) Due On 12/3/2024

0245 - BP-3 : SMS Rec Complex - C5,1 Rip-Rap Scope Responsibility

**Subject**

BP-3 : SMS Rec Complex - C5,1 Rip-Rap Scope Responsibility

**Status**

Closed by Clark ●

**Discipline**

Civil

**Phase**

Preconstruction

**Location**

Bid Pack #3 – Saline MS Rec  
Complex

**Created On**

11/26/2024

**Due Date**

12/3/2024

**Date Resolved**

11/26/2024

**Author**

Matt Wielechowski  
Clark Construction Company

**Resolved By**

Matt Wielechowski  
Clark Construction Company

**QUESTION** Matt Wielechowski on 11/26/2024 08:59 AM

What Bid Category is responsible for the Rip-Rap at the end of the concrete spillways (Detail Sheet C5.1)

**ANSWER** Matt Wielechowski on 11/26/2024 11:19 PM

Bid Category 31A - Sitework is responsible for the Rip-Rap at the end of the concrete spillways.

**ASSIGNMENTS**

Matt Wielechowski (Clark Construction Company) Due On 12/3/2024

0246 - BP-3 : SMS Rec Complex - C5,1 Rip-Rap Material Clarification

**Subject**

**Status**

BP-3 : SMS Rec Complex - C5,1 Rip-Rap Material Clarification

Closed by Clark ●

**Discipline**

**Phase**

**Location**

Civil

Preconstruction

Bid Pack #3 – Saline MS Rec  
Complex

**Created On**

**Due Date**

**Date Resolved**

11/26/2024

12/3/2024

11/26/2024

**Author**

**Resolved By**

Matt Wielechowski  
Clark Construction Company

Matt Wielechowski  
Clark Construction Company

**QUESTION** Matt Wielechowski on 11/26/2024 09:01 AM

The Rip-Rap detail for flared end sections on sheet C3.9 and Rip-Rap concrete spillways on sheet C5.1 note the material to be cobblestone. Will MDOT limestone Rip-Rap meeting the noted size requirements be acceptable to use for this project

**ANSWER** Matt Wielechowski on 11/26/2024 12:52 PM

Not at this time. Bid per plans. Alternative materials can be discussed with the owner prior to procurement.

**ASSIGNMENTS**

Trevor Garland (Kingscott Associates, Inc.) Due On 12/3/2024

0247 - BP-3 - SMS Rec Complex - Mechanical Pad Scope Responsibility

**Subject**

BP-3 - SMS Rec Complex - Mechanical Pad Scope Responsibility

**Status**

Closed by Clark ●

**Discipline**

Mechanical

**Phase**

Preconstruction

**Location**

Bid Pack #3 – Saline MS Rec  
Complex

**Created On**

11/26/2024

**Due Date**

12/3/2024

**Date Resolved**

11/26/2024

**Author**

Matt Wielechowski  
Clark Construction Company

**Resolved By**

Matt Wielechowski  
Clark Construction Company

**QUESTION** Matt Wielechowski on 11/26/2024 09:05 AM

Request to move Concrete Pads into the Concrete Bid Division. The plumbing division can supply Shop Drawings and coordinate installation.

**ANSWER** Matt Wielechowski on 11/26/2024 03:15 PM

Concrete mechanical pads are the responsibility of Bid Category 03 - Concrete per note 59. Concrete pads to be omitted from Bid Category 22 - Plumbing and HVAC.

**ASSIGNMENTS**

Matt Wielechowski (Clark Construction Company) Due On 12/3/2024

0248 - BP-3 - SMS Rec Complex - PTAC-2 Architectural Work Required

**Subject**

BP-3 - SMS Rec Complex - PTAC-2 Architectural Work Required

**Status**

Closed by Clark ●

**Discipline**

Mechanical

**Phase**

Preconstruction

**Location**

Bid Pack #3 – Saline MS Rec  
Complex

**Created On**

11/26/2024

**Due Date**

12/3/2024

**Date Resolved**

11/27/2024

**Author**

Matt Wielechowski  
Clark Construction Company

**Resolved By**

Matt Wielechowski  
Clark Construction Company

**QUESTION** Matt Wielechowski on 11/26/2024 09:12 AM

Is the architectural work needed for PTAC-2 in the existing concession area included in the Plumbing Scope?

**ANSWER** Matt Wielechowski on 11/27/2024 07:40 AM

Bid Category 04 - Masonry is responsible for work associated with PTAC-2 as shown on M1.1. This included necessary demo, masonry and installation of lintel per M1.1, "Existing Concessions - Mechanical Plan".

**ASSIGNMENTS**

Matt Wielechowski (Clark Construction Company) Due On 12/3/2024

Trevor Garland (Kingscott Associates, Inc.) Due On 12/3/2024

0249 - BP-3 - SMS Rec Complex - Placement and fine grading sand scope clarification

**Subject**

BP-3 - SMS Rec Complex - Placement and fine grading sand scope clarification

**Status**

Closed by Clark ●

**Discipline**

Mechanical

**Phase**

Preconstruction

**Location**

Bid Pack #3 – Saline MS Rec  
Complex

**Created On**

11/26/2024

**Due Date**

12/3/2024

**Date Resolved**

11/27/2024

**Author**

Matt Wielechowski  
Clark Construction Company

**Resolved By**

Matt Wielechowski  
Clark Construction Company

**QUESTION** Matt Wielechowski on 11/26/2024 09:15 AM

Please clarify for the below item in BP 31A for what and where we are placing this sand. I see the sand placement for all site concrete in BP #03 and the stone base in BP #32A.

Bid Category 31A - Item #16: Placing and fine grading sand required between surfaces such as asphalt and concrete.

**ANSWER** Matt Wielechowski on 11/27/2024 07:34 AM

See attached for clarification.

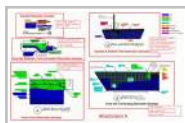

File

Attachment A - Si...  
Matt Wielechowski

**ASSIGNMENTS**

Matt Wielechowski (Clark Construction Company) Due On 12/3/2024

## Asphalt Delineation Example

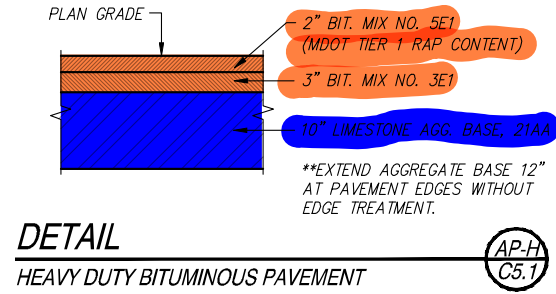

- 31A - Furnish, Grade and Compact 6" Class II Sand Base
- 32A - Fine Grade

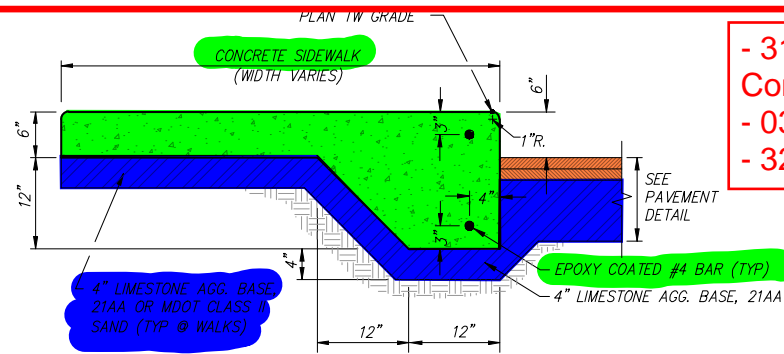

- 31A - Furnish, Grade and Compact 6" Class II Sand Base
- 03 - Fine Grade
- 32A - Fine Grade

## Concrete Sidewalk, Curb and Asphalt Delineation Example

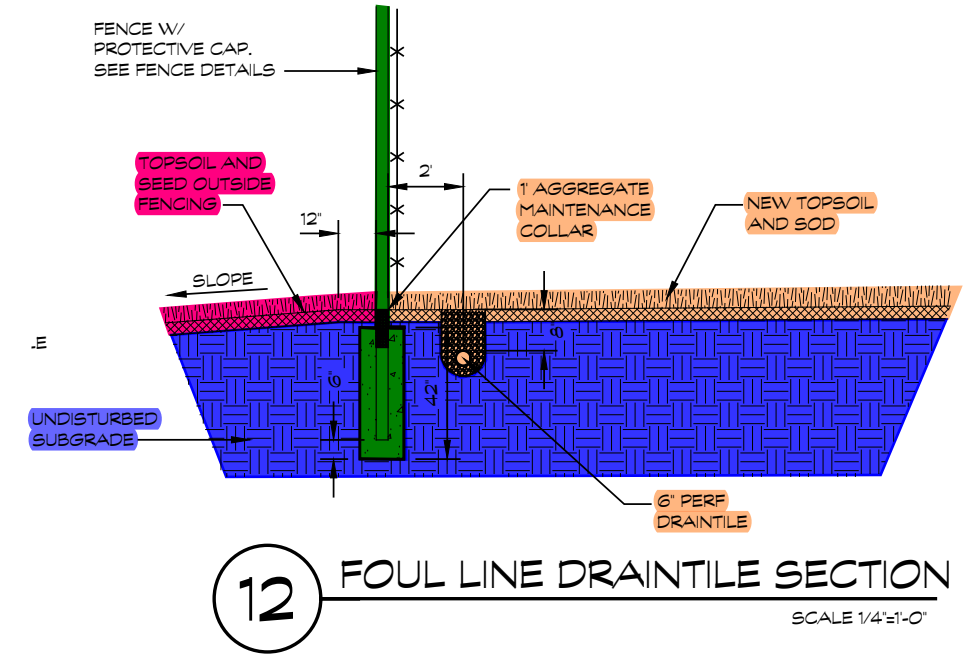

- 31A - Grade and compact subgrade as required
- 31B - Furnish, place and grade topsoil, sod, maintenance strip, etc. inside baseball fields
- 32F - Furnish, place and grade topsoil, seed, mulch, etc. all other areas

## Baseball & Softball Field Delineation Example

- 31A - Sitework
- 32A - Asphalt
- 03 - Concrete
- 32B - Turf
- 32C - Track Surface
- 32F - Landscaping
- 31B - Ball Field Sitework
- 32D - Tennis Court Surfacing

- 31A - Furnish, Grade and Compact 6" Class II Sand Base
- 03 - Fine Grade

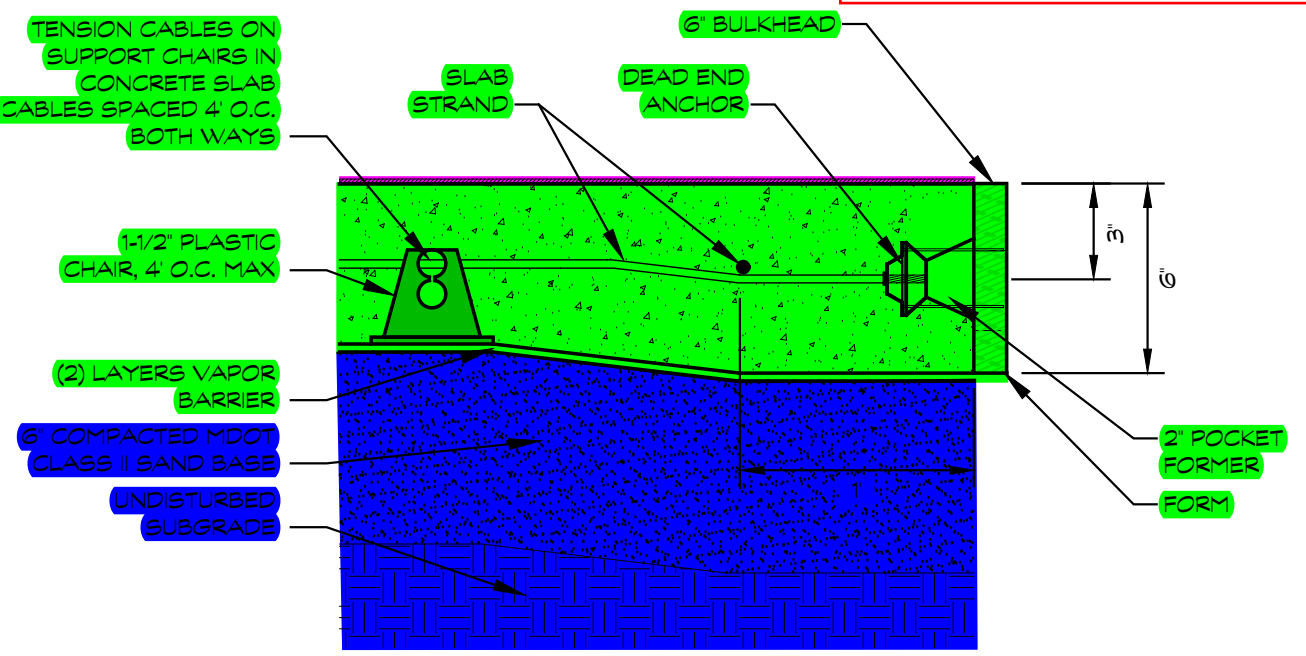

## Tennis Court Delineation Example

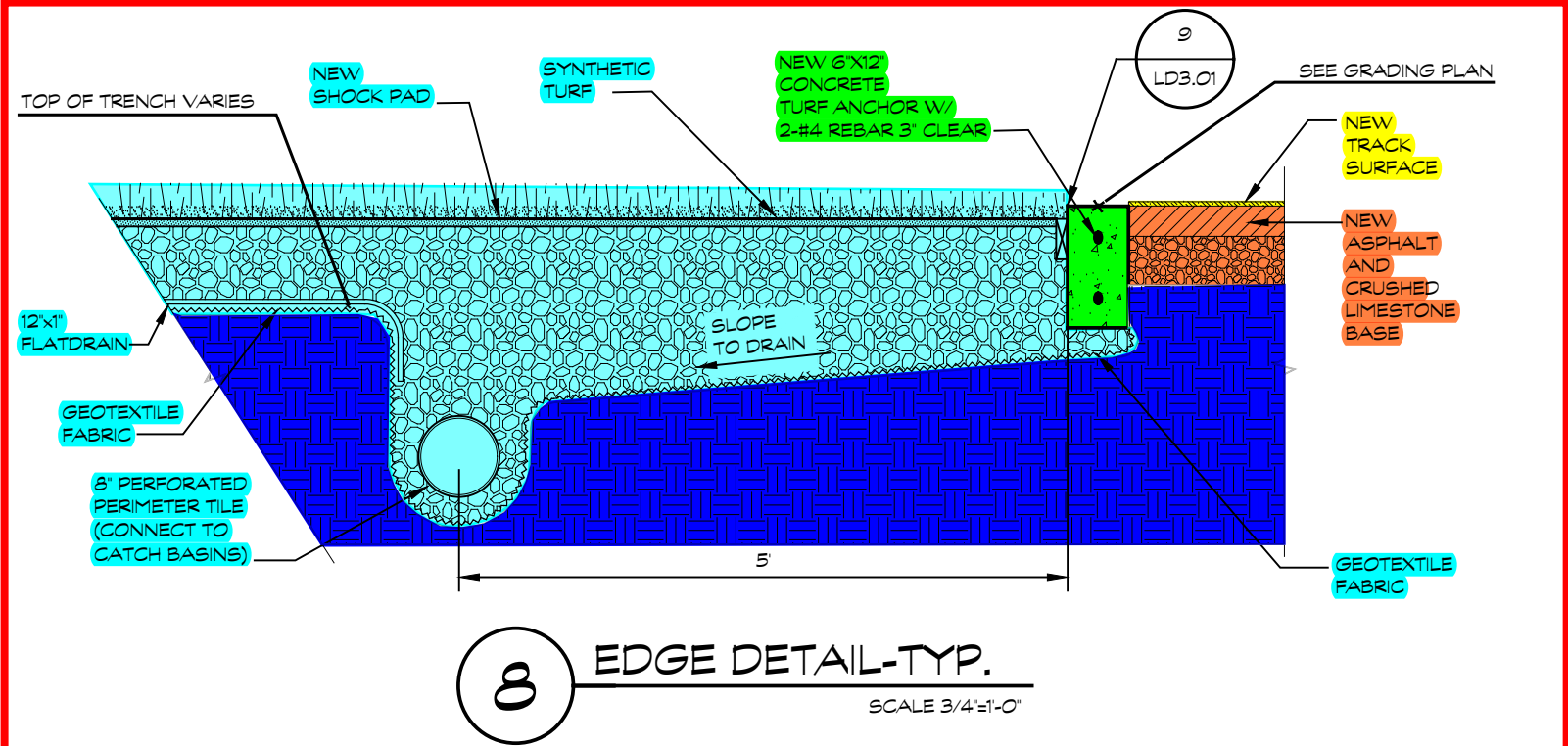

## Track and Turf Grading Delineation Example

- 31A - Grade site
- 32A - Furnish, grade and compact stone base for track
- 32B - Furnish, grade and compact stone for turf areas

# Attachment A

# Baseball / Softball Delineation Example #2

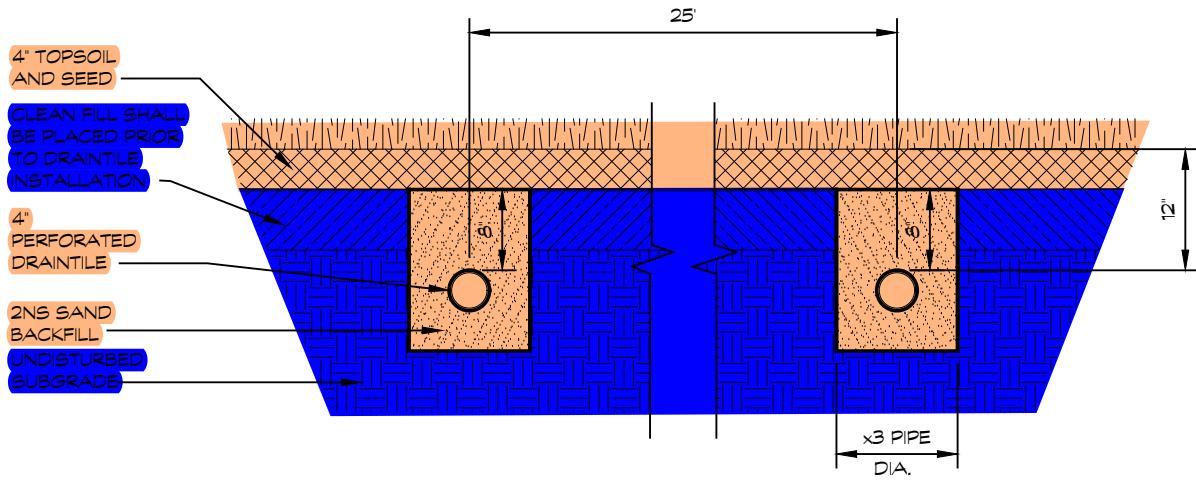

**13** 4" DRAINTILE SECTION  
SCALE 3/4"=1'-0"

- 31A - Sitework
- 32A - Asphalt
- 03 - Concrete
- 32B - Turf
- 32C - Track Surface
- 32F - Landscaping
- 31B - Ball Field Sitework
- 32D - Tennis Court Surfacing



0250 - BP-3 - SMS Rec Complex - Haul off the existing stockpile

**Subject**

BP-3 - SMS Rec Complex - Haul off the existing stockpile

**Status**

Closed by Clark ●

**Discipline**

Civil

**Phase**

Preconstruction

**Location**

Bid Pack #3 – Saline MS Rec  
Complex

**Created On**

11/26/2024

**Due Date**

12/3/2024

**Date Resolved**

11/26/2024

**Author**

Matt Wielechowski  
Clark Construction Company

**Resolved By**

Matt Wielechowski  
Clark Construction Company

**QUESTION** Matt Wielechowski on 11/26/2024 09:17 AM

On demo sheet C 2.3, there is a note to haul off the existing stockpile or use for fill. Can we get a quantity for the stockpile, and it is not needed to balance the site.

**ANSWER** Matt Wielechowski on 11/26/2024 03:16 PM

Include an allowance of \$100,000 for removal of existing stockpile. Bid Category specific notes for 31A - Sitework have been updated to include this allowance in Addendum 002.

**ASSIGNMENTS**

Matt Wielechowski (Clark Construction Company) Due On 12/3/2024

0252 - BP-3 : SMS Rec Complex - Turf Detail Clarifications

**Subject**

BP-3 : SMS Rec Complex - Turf Detail Clarifications

**Status**

Closed by Clark ●

**Discipline**

All Disciplines

**Phase**

Preconstruction

**Location**

Bid Pack #3 – Saline MS Rec  
Complex

**Created On**

11/26/2024

**Due Date**

12/3/2024

**Date Resolved**

11/27/2024

**Author**

Matt Wielechowski  
Clark Construction Company

**Resolved By**

Matt Wielechowski  
Clark Construction Company

**QUESTION** Matt Wielechowski on 11/26/2024 10:44 AM

1. Which edge detail are we to use for base profile for the synthetic turf? Detail 5 or Detail 8 shown on LD3.01?
2. Radius Point Marker - should this be on the track installer? Detail 4 on LD3.01.
3. Is Bid Category 32B stubbing pipe into the structure or is the civil contractor brining pipe into the field for us to tie into?
4. Access Boxes, who's scope are they in? There are some boxes located within the track surface that would not be typical for BC 32B - Synthetic Turf to provide.

**ANSWER** Matt Wielechowski on 11/26/2024 11:16 PM (Promoted by Matt Wielechowski on 11/27/2024 11:21 AM)

Responses:

1. Both are applicable and illustrate the same intent.
2. Bid Category 32A - Asphalt Paving is responsible for the Radius Point Marker. Bid Category 32C - Track Surface is required to confirm radius prior to installation of track surface.
3. Bid Category 32B is responsible for installing drain tile 5' outside of the fields. From there Bid Category 31A is responsible to tie onto and install to catch basin.
4. Bid Category 32B is responsible for furnishing and installing access boxes. Coordinate location and connections with Electrical Contractor. Bid Category 26 - Electrical is responsible for electrical work associated with

**ASSIGNMENTS**

Trevor Garland (Kingscott Associates, Inc.) Due On 12/3/2024

Matt Wielechowski (Clark Construction Company) Due On 12/3/2024

0253 - BP-3 : SMS Rec Complex - C2.2 Demolition Notes 14 and 15 Clarification

**Subject**

BP-3 : SMS Rec Complex - C2.2 Demolition Notes 14 and 15 Clarification

**Status**

Closed by Clark ●

**Discipline**

Civil

**Phase**

Preconstruction

**Location**

Bid Pack #3 – Saline MS Rec  
Complex

**Created On**

11/26/2024

**Due Date**

12/3/2024

**Date Resolved**

11/26/2024

**Author**

Matt Wielechowski  
Clark Construction Company

**Resolved By**

Matt Wielechowski  
Clark Construction Company

**QUESTION** Matt Wielechowski on 11/26/2024 12:40 PM

On sheet C2.2, demolition notes 14 (remove) & 15(abandon) are used intermittently (and inconsistently relative to the line symbol) on the drain line for the track. Please correct and if possible, explain the purpose of both being used.

**ANSWER** Matt Wielechowski on 11/26/2024 03:19 PM

There is one plan call out that is inconsistent as shown in the attached document. The highlighted call-out 15 should be 14. Otherwise, all other callouts and line types are used correctly. The intent of abandoning vs removing is when a pipe is exposed or in conflict with an improvement then it should be removed. If the pipe will not be exposed and will not be in conflict with other amenities, then it can remain in place and be abandoned.



File

RFI 0253 Demo not...  
Matt Wielechowski

**ASSIGNMENTS**

Trevor Garland (Kingscott Associates, Inc.) Due On 12/3/2024

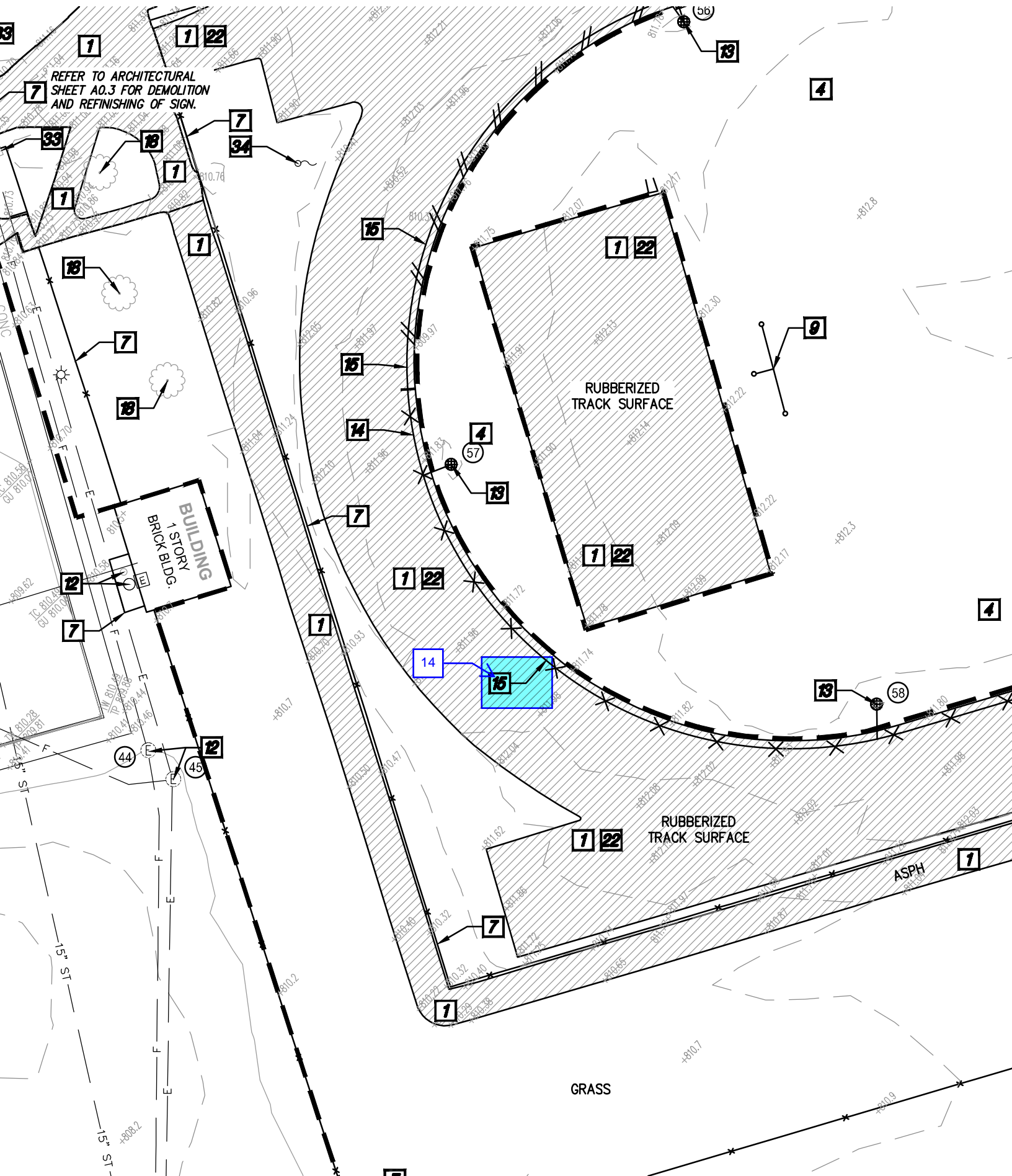

0254 - BP-3 : SMS Rec Complex - Bid Category 31A - Permit Cost Clarification

**Subject**

BP-3 : SMS Rec Complex - Bid Category 31A - Permit Cost Clarification

**Status**

Closed by Clark ●

**Discipline**

Civil

**Phase**

Preconstruction

**Location**

Bid Pack #3 – Saline MS Rec  
Complex

**Created On**

11/26/2024

**Due Date**

12/3/2024

**Date Resolved**

11/26/2024

**Author**

Matt Wielechowski  
Clark Construction Company

**Resolved By**

Matt Wielechowski  
Clark Construction Company

**QUESTION** Matt Wielechowski on 11/26/2024 12:41 PM

Please consider providing an allowance for the permitting task. There is no way to accurately bid this due to the number of unknowns in its determination and the control by other parties (and the weather) in its cost.

**ANSWER** Matt Wielechowski on 11/26/2024 11:37 PM

See Addendum 002 for added allowances to Bid Category Specific Notes.

**ASSIGNMENTS**

Matt Wielechowski (Clark Construction Company) Due On 12/3/2024

Trevor Garland (Kingscott Associates, Inc.) Due On 12/3/2024

0255 - BP-3 : SMS Rec Complex - Landscaping and Tree Clarification

**Subject**

BP-3 : SMS Rec Complex - Landscaping and Tree Clarification

**Status**

Closed by Clark ●

**Discipline**

Civil

**Phase**

Preconstruction

**Location**

Bid Pack #3 – Saline MS Rec  
Complex

**Created On**

11/26/2024

**Due Date**

12/3/2024

**Date Resolved**

11/27/2024

**Author**

Matt Wielechowski  
Clark Construction Company

**Resolved By**

Matt Wielechowski  
Clark Construction Company

**QUESTION** Matt Wielechowski on 11/26/2024 02:50 PM

Do you know the sizes (Cal.) of the trees requested?

Are there any sod or seed areas? I saw in addendum 1 that baseball/softball field areas have sod over 4" topsoil but is this the only area that requires this? I do not see it detailed anywhere else in the provided documents.

**ANSWER** Matt Wielechowski on 11/27/2024 08:40 AM

1. 2.5" caliper trees

2. The intent for the limits of sod are within the ballfields only. All other disturbed areas outside of the ballfields required topsoil, seed and mulch per specification 329200 - Turfs and Grasses, 329220 - Topsoil. See scope delineation in Addendum 002 identifying ball field landscaping requirements (31B) vs. 32F - Lanscaping.

**ASSIGNMENTS**

Matt Wielechowski (Clark Construction Company) Due On 12/3/2024

Trevor Garland (Kingscott Associates, Inc.) Done On 11/27/2024

0256 - BP-3 : SMS Rec Complex - LD3.01 Detail 7 and 8 - Finishing Stone for Athletic Fields

**Subject**

**Status**

BP-3 : SMS Rec Complex - LD3.01 Detail 7 and 8 - Finishing Stone for Athletic Fields

Closed by Clark ●

**Discipline**

**Phase**

**Location**

Civil

Preconstruction

Bid Pack #3 – Saline MS Rec  
Complex

**Created On**

**Due Date**

**Date Resolved**

11/26/2024

12/3/2024

11/26/2024

**Author**

**Resolved By**

Matt Wielechowski  
Clark Construction Company

Holli Durchik  
Forsite Design

**QUESTION** Matt Wielechowski on 11/26/2024 03:34 PM

The detail for the base stone shows 8" with no finishing stone, is that correct. Pg. LD3.01 detail 7 and 8. All the other projects we've done has 1" of finishing stone. please advise. Also, the site contractor is going to get the baseball and softball fields as well as the football and soccer fields to sub-grade, correct?

**ANSWER** Holli Durchik on 11/26/2024 03:43 PM (Promoted by Matt Wielechowski on 11/26/2024 11:21 PM)

The intent for the total profile of the Aggregate Drainage Layer is 8" refer to Specification Section 32 1123 Aggregate Drainage Layer for stone type and depths.

**ASSIGNMENTS**

Matt Wielechowski (Clark Construction Company) Due On 12/3/2024

Trevor Garland (Kingscott Associates, Inc.) Due On 12/3/2024